

FRONT ELEVATION

Property of TK Constructors, Inc.



**ITEMS LOCATED AT PCM**

1-44	Basement rough in for full bath. Includes a sealed sewage pit that is connected to your plumbing rough in and a grinder ejector pump to force the sewage up to main sewer line. to be placed at the PCM Each 1.00
1-49	Designated Circuit for Hot Tub To be placed at the PCM Each 1.00
1-50	Add exterior Motion Floodlight Flani placement at the PCM Each 1.00
1-66	white crown molding around the entire ceiling on the first floor: 4 - 5/8" Price per Tracy Rice. Note the tray ceiling will be deleted in the dining room. (see option #109) Each 1.00"
1-78	Zone heating and cooling system. A typical zone heating and cooling system is comprised of automatic dampers installed in the ductwork of the system. The idea of this system is to heat or cool separate floors of the house at different times if needed. You have two thermostats controlling one furnace. There are two separate duct trunk lines. One for the main floor and another for the second floor (upstairs). Price per Tracy Rice Each 1.00"

**ANDERSEN WINDOW SCHEDULE - 200 SERIES -**

ANDERSEN MODEL NO.	R.O. SIZE
3030	36" x 36"
3040	36" x 48"
3049*	36" x 57"
3056*	36" x 66"
3060*	36" x 72"
3049 MULL*	73" x 57"
3056 MULL*	73" x 66"
3060 MULL*	73" x 72"

**ANDERSEN SLIDING DOOR**  
R.O. 72 3/4" x 82 1/8"

3'-0" FRONT DOOR  
R.O. 38 3/8" x 82 1/2"

3'-0" FRONT DOOR WITH (1) SIDELITE  
R.O. 51 7/8" x 82 1/2"

3'-0" FRONT DOOR WITH (2) SIDELITES  
R.O. 65 3/8" x 82 1/2"

R.O. FOR BI-FOLD DOORS USING DRYWALL  
JAMB FACING = 1 1/4" + DOOR SIZE x (81 1/2")

R.O. FOR BYPASS DOORS USING DRYWALL  
JAMB FACING MAKE SAME AS BOTH DOORS  
ADDED TOGETHER

ALL INTERIOR DOORS  
SIZE + 2" TO WIDTH x 82 1/2" HIGH

R.O. POCKET DOOR  
(2x DOOR WIDTH + 1") x 85" HIGH

\* - DENOTES OPENING MEETS  
EGRESS REQUIREMENTS

**9'-0" FIRST FLOOR  
CEILING HEIGHT 1-32**

INCLUDES:

1.	4 1/4" BASEBOARDS IN LIEU OF 3 1/4"
2.	3060 WINDOWS IN LIEU OF 3056 WINDOWS
3.	3056 WINDOWS IN LIEU OF 3049 WINDOWS
4.	DRYWALL WRAPPED OPENINGS 12" TALLER
5.	42" KITCHEN CABINETS 1-31
6.	(2) 9'x8' OVERHEAD GARAGE DOORS 1-119

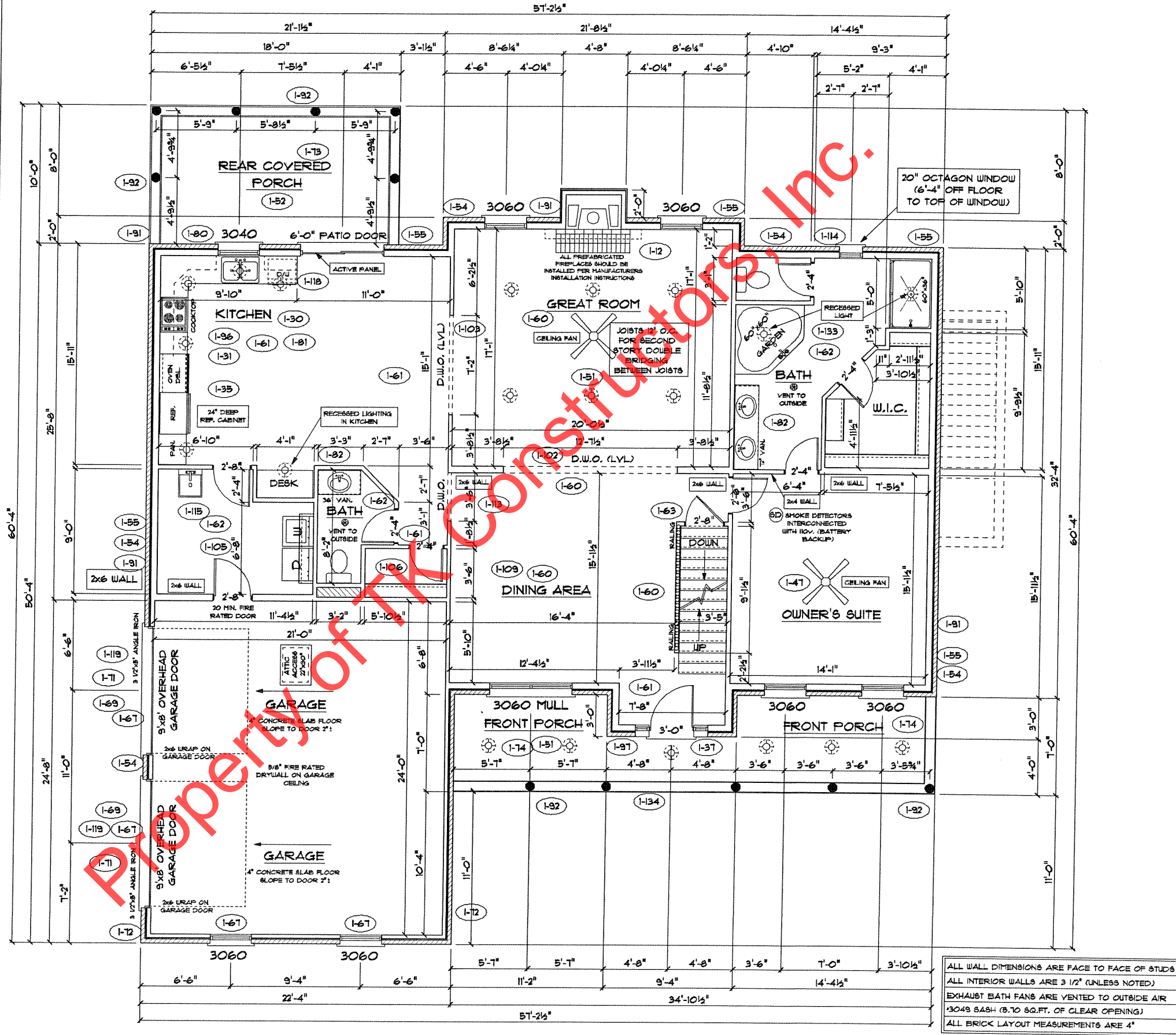

FIRST FLOOR PLAN

ALL WALL DIMENSIONS ARE FACE TO FACE OF STUDS  
ALL INTERIOR WALLS ARE 3/2" (UNLESS NOTED)  
EXHAUST BATH FANS ARE VENTED TO OUTSIDE AIR  
3049 BASH (8.70 SQ.FT. OF CLEAR OPENING)  
ALL BRICK LAYOUT MEASUREMENTS ARE 4"



**SECOND FLOOR PLAN**

FIRST FLOOR SQ.FT.	1,716
SECOND FLOOR SQ.FT.	1,109
TOTAL LIVING SQ.FT.	2,885
GARAGE	546
TOTAL SQ.FT.	3,431
EXCLUDING FRONT PORCH	216
EXCLUDING REAR PORCH	180

**ANDERSEN WINDOW SCHEDULE  
- 200 SERIES -**

ANDERSEN MODEL NO.	R.O. SIZE
3030	36" x 36"
3040	36" x 48"
3049*	36" x 57"
3056*	36" x 66"
3060*	36" x 72"
3049 MULL*	73" x 57"
3056 MULL*	73" x 66"
3060 MULL*	73" x 72"

  

ANDERSEN SLIDING DOOR R.O. 12 3/4" x 82 1/8"
3'-0" FRONT DOOR R.O. 38 3/8" x 82 1/2"
3'-0" FRONT DOOR WITH (1) SIDELITE R.O. 51 7/8" x 82 1/2"
3'-0" FRONT DOOR WITH (2) SIDELITES R.O. 65 3/8" x 82 1/2"
R.O. FOR BI-FOLD DOORS USING DRYWALL JAMB FACING = 1 1/4" + DOOR SIZE x (81 1/2")
R.O. FOR BYPASS DOORS USING DRYWALL JAMB FACING MAKE SAME AS BOTH DOORS ADDED TOGETHER
ALL INTERIOR DOORS SIZE + 2" TO WIDTH x 82 1/2" HIGH
R.O. POCKET DOOR (2x DOOR WIDTH + 1") x 85" HIGH

\* - DENOTES OPENING MEETS  
EGRESS REQUIREMENTS

**9'-0" FIRST FLOOR (1-129)  
CEILING HEIGHT (SECOND FLOOR)**

INCLUDES:
1. 4 1/4" BASEBOARDS IN LIEU OF 3 1/4"

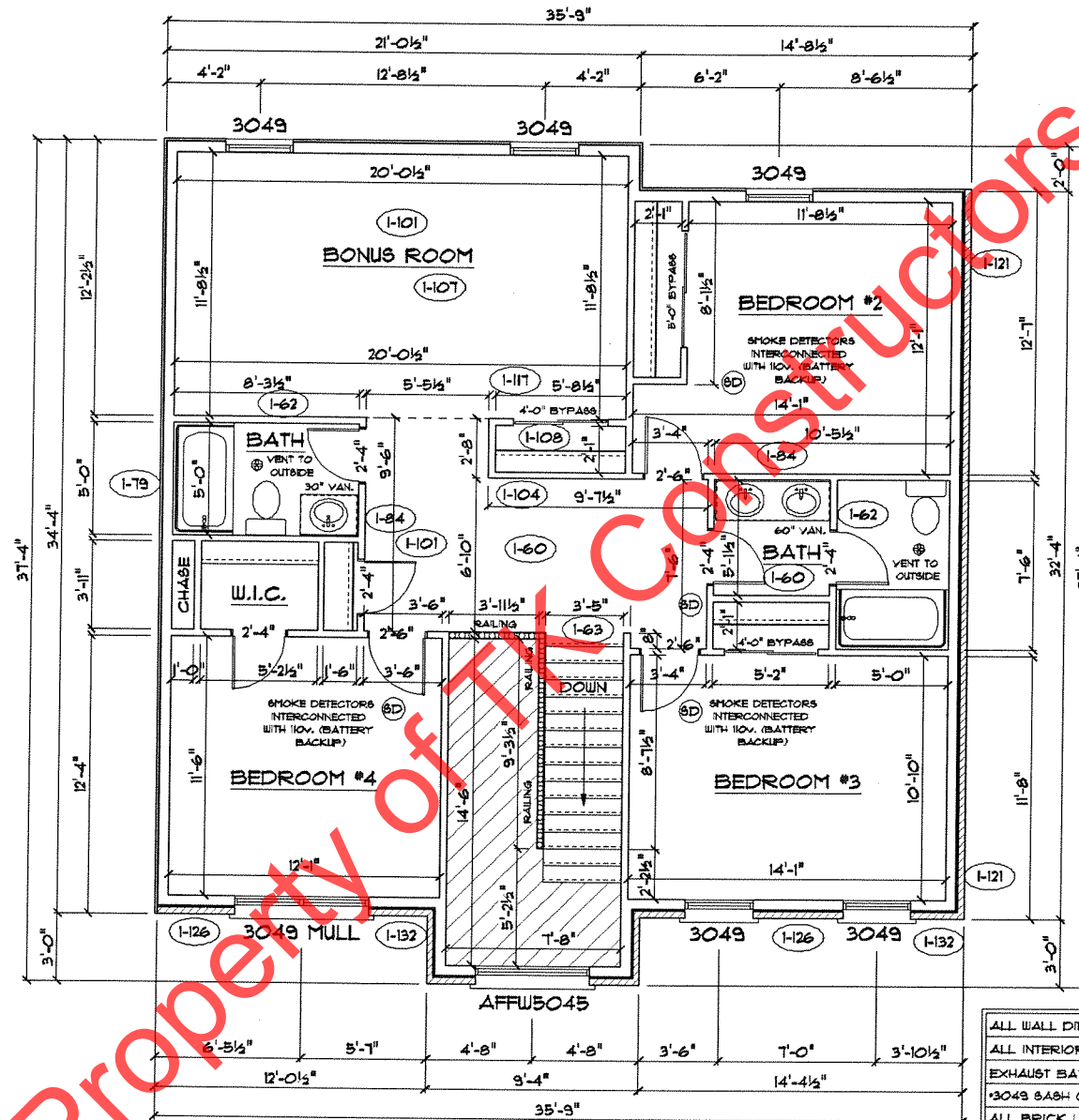

**ITEMS LOCATED AT PCM**

(1-44)	Basement rough in for full bath. Includes a sealed sewage pit that is connected to your plumbing rough in and a grinder ejector pump to force the sewage up to main sewer line. to be placed at the PCM Each 1.00
(1-49)	Designated Circuit for Hot Tub To be placed at the PCM Each 1.00
(1-50)	Add exterior Motion Floodlight Flant placement at the PCM Each 1.00
(1-66)	white crown molding around the entire ceiling on the first floor: 4 - 5/8" Price per Tracy Rice. Note the tray ceiling will be deleted in the dining room. (see option #109) Each 1.00"
(1-78)	Zone heating and cooling system. A typical zone heating and cooling system is comprised of automatic dampers installed in the ductwork of the system. The idea of this system is to heat or cool separate floors of the house at different times if needed. You have two thermostats controlling one furnace. There are two separate duct trunk lines. One for the main floor and another for the second floor (upstairs). Price per Tracy Rice Each 1.00"

ALL WALL DIMENSIONS ARE FACE TO FACE OF STUDS  
ALL INTERIOR WALLS ARE 3 1/2" (UNLESS NOTED)  
EXHAUST BATH FANS ARE VENTED TO OUTSIDE AIR  
3049 SASH (8.70 SQ.FT. OF CLEAR OPENING)  
ALL BRICK LAYOUT MEASUREMENTS ARE 4"



CONSTRUCTORS