

FRONT ELEVATION

NOTE: STOOPS, STEPS, APRON
 AND DRIVE BY OWNER

GRADE JULY
 FROM FOUNDATION
 BY OWNER

GRADE JULY
 FROM FOUNDATION
 BY OWNER

Property of TK Constructors, Inc.

ALL WALL DIMENSIONS ARE FACE OF STUDS
 ALL INTERIOR WALLS ARE 3 1/2" (UNLESS NOTED)
 EXHAUST BATH FANS ARE VENTED TO OUTSIDE AIR
 *9049 SASH (S. TO 66. FT. OF CLEAR OPENING)
 ALL BRICK LAYOUT MEASUREMENTS ARE 4"

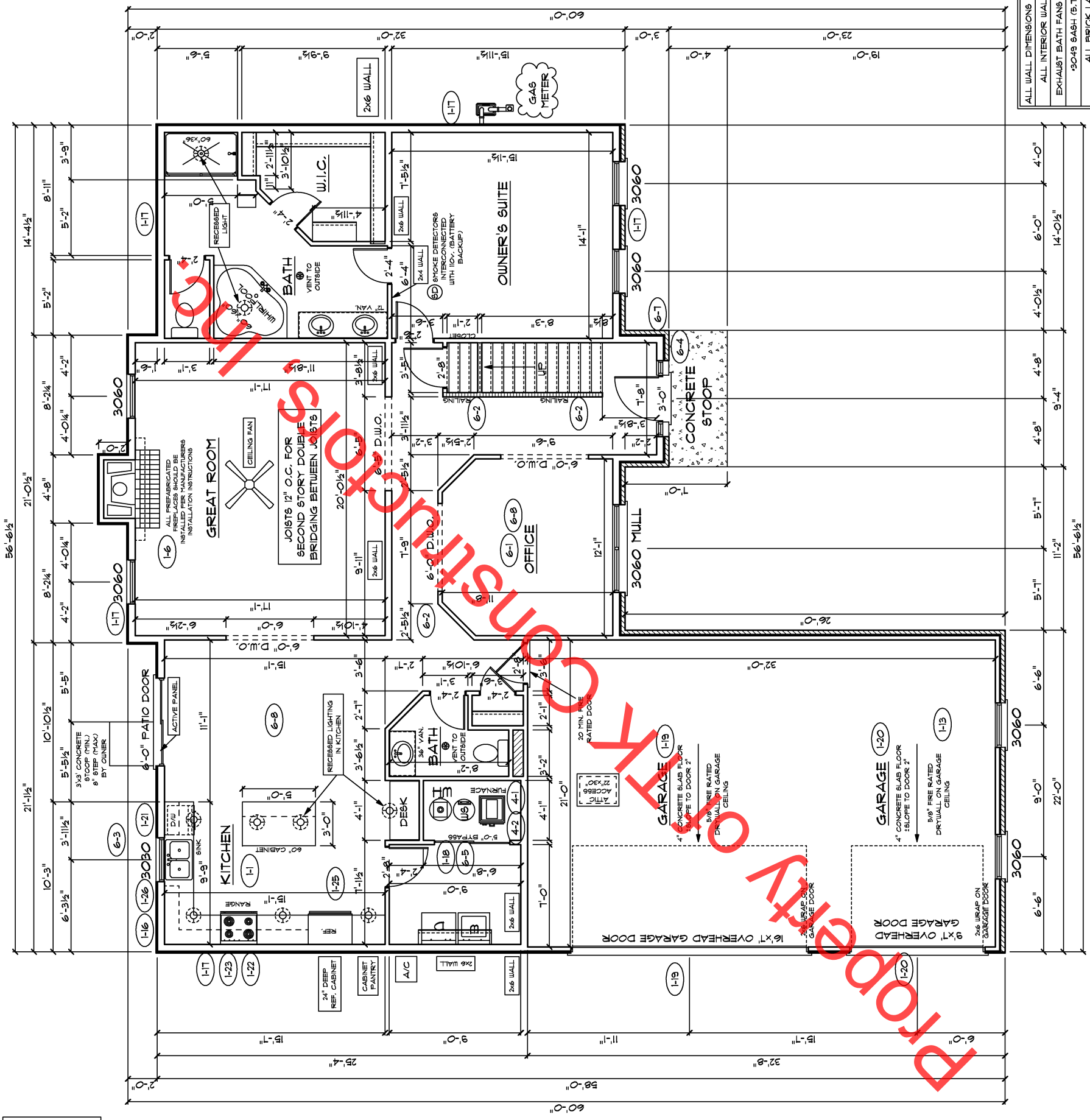

PURE WHITE INTERIOR PAINT ON (6-9)
 ALL WALLS, CEILING, AND TRIM
 (FLAT PAINT ON THE WALLS AND CEILING;
 SEMI-GLOSS ON THE TRIM)

ENTIRE HOUSE TO BE SOFT
 WATER - INCLUDING (6-6)
 KITCHEN COLD AND ICEMAKER

(4-4) (4-5)
FIRST FLOOR PLAN

**ANDERSEN WINDOW SCHEDULE
 - 200 SERIES -**

| ANDERSEN MODEL NO. | R.O. SIZE |
|--|-----------|
| 3030 | 36" x 36" |
| 3040 | 36" x 48" |
| 3049* | 36" x 51" |
| 3056* | 36" x 66" |
| 3060* | 36" x 72" |
| 3049 MULL* | 13" x 51" |
| 3056 MULL* | 13" x 66" |
| 3060 MULL* | 13" x 72" |
| ANDERSEN SLIDING DOOR R.O. 72 3/4" x 82 1/8" | |
| 3'-0" FRONT DOOR R.O. 38 3/8" x 82 1/2" | |
| 3'-0" FRONT DOOR WITH (1) SIDELITE R.O. 51 7/8" x 82 1/2" | |
| 3'-0" FRONT DOOR WITH (2) SIDELITES R.O. 65 3/8" x 82 1/2" | |
| R.O. FOR BIFOLD DOORS USING DRYWALL JAMB FACING = 1 1/4" + DOOR SIZE x (81 1/2") | |
| R.O. FOR BYPASS DOORS USING DRYWALL JAMB FACING MAKE SAME AS BOTH DOORS ADDED TOGETHER | |
| ALL INTERIOR DOORS SIZE + 2" TO WIDTH x 82 1/2" HIGH | |
| R.O. POCKET DOOR (2x DOOR WIDTH + 1") x 85" HIGH | |

* DENOTES OPENING MEETS
 EGRESS REQUIREMENTS

9'-0" FIRST FLOOR CEILING HEIGHT (1-15)

INCLUDES:

- 4 1/4" BASEBOARDS IN LIEU OF 3 1/4"
- 3060 WINDOW IN LIEU OF 3056 WINDOW
- 3056 WINDOW IN LIEU OF 3049 WINDOW
- DRYWALL WRAPPED OPENINGS 12" TALLER
- 30" KITCHEN CABINETS STANDARD
- 16xT GARAGE DOOR STANDARD

(44) (45)
SECOND FLOOR PLAN

| | |
|---------------------|-------|
| FIRST FLOOR SQ.FT. | 1,740 |
| SECOND FLOOR SQ.FT. | 1,101 |
| TOTAL LIVING SQ.FT. | 2,841 |
| GARAGE | 715 |
| TOTAL SQ.FT. | 3,556 |
| EXCLUDING PORCH | 37 |

| ANDERSEN WINDOW SCHEDULE - 200 SERIES - | |
|--|-----------|
| ANDERSEN MODEL NO. | R.O. SIZE |
| 3030 | 36" x 36" |
| 3040 | 36" x 48" |
| 3049* | 36" x 57" |
| 3056* | 36" x 66" |
| 3060* | 36" x 72" |
| 3049 MULL* | 73" x 57" |
| 3056 MULL* | 73" x 66" |
| 3060 MULL* | 73" x 72" |
| ANDERSEN SLIDING DOOR R.O. 72 3/4" x 82 1/8" | |
| 3'-0" FRONT DOOR R.O. 38 3/8" x 82 1/2" | |
| 3'-0" FRONT DOOR WITH (1) SIDELITE R.O. 51 7/8" x 82 1/2" | |
| 3'-0" FRONT DOOR WITH (2) SIDELITES R.O. 65 3/8" x 82 1/2" | |
| R.O. FOR BI-FOLD DOORS USING DRYWALL JAMB FACING = 1 1/4" * DOOR SIZE x (81 1/2") | |
| R.O. FOR BYPASS DOORS USING DRYWALL JAMB FACING MAKE SAME AS BOTH DOORS ADDED TOGETHER | |
| ALL INTERIOR DOORS SIZE * 2" TO WIDTH x 82 1/2" HIGH | |
| R.O. POCKET DOOR (2x DOOR WIDTH * 1") x 85" HIGH | |

* DENOTES OPENING MEETS
EGRESS REQUIREMENTS

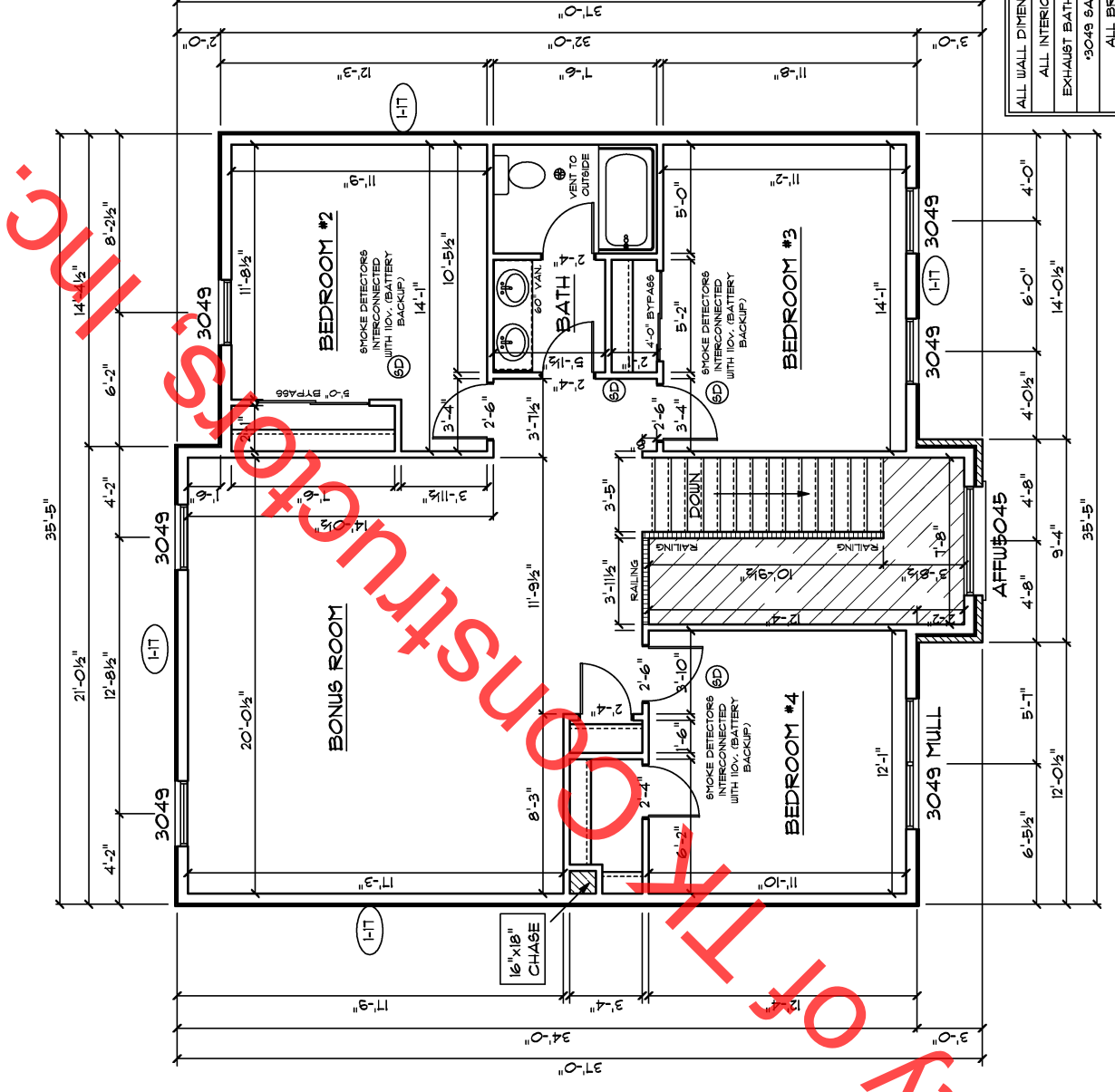

ALL WALL DIMENSIONS ARE FACE TO FACE OF STUDS
 ALL INTERIOR WALLS ARE 3 1/2" (UNLESS NOTED)
 EXHAUST BATH FANS ARE VENTED TO OUTSIDE AIR
 3049 SASH (5.10 SQ.FT. OF CLEAR OPENING)
 ALL BRICK LAYOUT MEASUREMENTS ARE 4"