

FRONT ELEVATION



1-25
FIRST FLOOR PLAN

| ANDERSEN WINDOW SCHEDULE - 200 SERIES - | |
|--|-----------|
| ANDERSEN MODEL NO. | R.O. SIZE |
| 3030 | 36" x 36" |
| 3040 | 36" x 48" |
| 3049* | 36" x 51" |
| 3056* | 36" x 66" |
| 3060* | 36" x 72" |
| 3049 MULL* | 73" x 51" |
| 3056 MULL* | 73" x 66" |
| 3060 MULL* | 73" x 72" |
| ANDERSEN SLIDING DOOR R.O. 72 3/4" x 82 1/8" | |
| 3'-0" FRONT DOOR R.O. 38 3/8" x 82 1/2" | |
| 3'-0" FRONT DOOR WITH (1) SIDELITE R.O. 51 1/8" x 82 1/2" | |
| 3'-0" FRONT DOOR WITH (2) SIDELITES R.O. 65 3/8" x 82 1/2" | |
| R.O. FOR BI-FOLD DOORS USING DRYWALL JAMB FACING = 1 1/4" + DOOR SIZE x (81 1/2") | |
| R.O. FOR BYPASS DOORS USING DRYWALL JAMB FACING MAKE SAME AS BOTH DOORS ADDED TOGETHER | |
| ALL INTERIOR DOORS SIZE + 2" TO WIDTH x 82 1/2" HIGH | |
| R.O. POCKET DOOR (2x DOOR WIDTH + 1") x 85" HIGH | |

* - DENOTES OPENING MEETS
EGRESS REQUIREMENTS

| 9'-0" TRAY CEILING 1-26 | |
|-------------------------------|--|
| - 10" DOWN FROM 9'-0" HEIGHT | |
| - 20" WIDE FROM EXTERIOR WALL | |
| - 30" CORNER | |

| 9'-0" FIRST FLOOR CEILING HEIGHT | |
|-------------------------------------|--------------------------------------|
| INCLUDES: | |
| 1. | 4 1/4" BASEBOARDS IN LIEU OF 3 1/4" |
| 2. | 3060 WINDOWS IN LIEU OF 3056 WINDOWS |
| 3. | 3056 WINDOWS IN LIEU OF 3049 WINDOWS |
| 4. | DRYWALL WRAPPED OPENINGS 12" TALLER |
| 5. | 42" KITCHEN CABINETS STANDARD |
| 6. | 16'x8' GARAGE DOOR STANDARD |

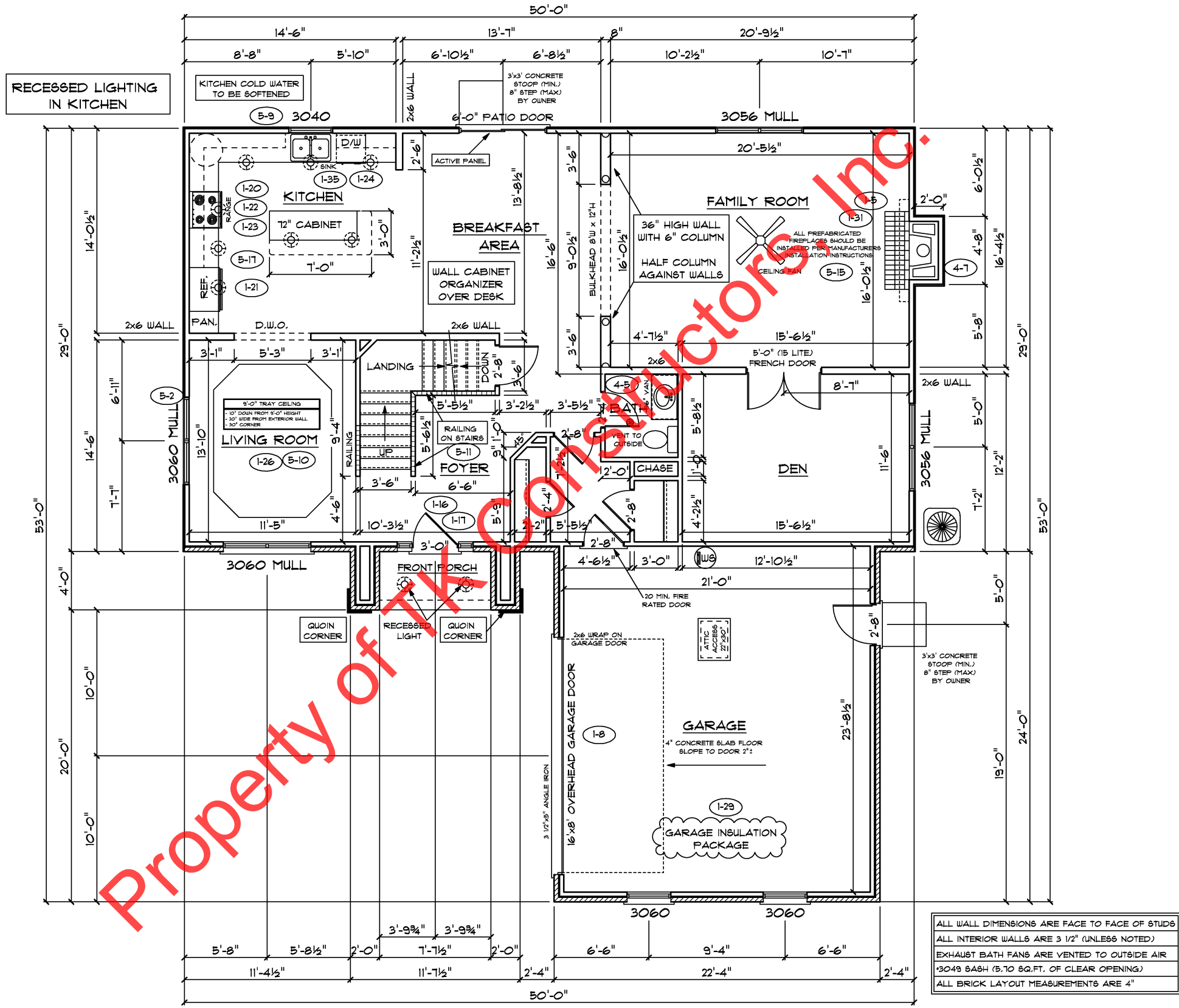

ALL WALL DIMENSIONS ARE FACE TO FACE OF STUDS
ALL INTERIOR WALLS ARE 3 1/2" (UNLESS NOTED)
EXHAUST BATH FANS ARE VENTED TO OUTSIDE AIR
#3049 SASH (5.70 SQ.FT. OF CLEAR OPENING)
ALL BRICK LAYOUT MEASUREMENTS ARE 4"

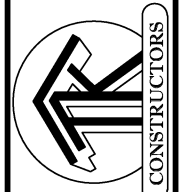

SECOND FLOOR PLAN

| | |
|---------------------|-------|
| FIRST FLOOR SQ.FT. | 1,449 |
| SECOND FLOOR SQ.FT. | 1,326 |
| TOTAL LIVING SQ.FT. | 2,775 |
| GARAGE | 536 |
| TOTAL SQ.FT. | 3,311 |
| EXCLUDING PORCH | 46 |

**ANDERSEN WINDOW SCHEDULE
- 200 SERIES -**

| ANDERSEN MODEL NO. | R.O. SIZE |
|--------------------|-----------|
| 3030 | 36" x 36" |
| 3040 | 36" x 48" |
| 3049* | 36" x 57" |
| 3056* | 36" x 66" |
| 3060* | 36" x 72" |
| 3049 MULL* | 73" x 57" |
| 3056 MULL* | 73" x 66" |
| 3060 MULL* | 73" x 72" |

ANDERSEN SLIDING DOOR
R.O. 72 3/4" x 82 1/8"

3'-0" FRONT DOOR
R.O. 38 3/8" x 82 1/2"

3'-0" FRONT DOOR WITH (1) SIDELITE
R.O. 51 1/8" x 82 1/2"

3'-0" FRONT DOOR WITH (2) SIDELITES
R.O. 65 3/8" x 82 1/2"

R.O. FOR BI-FOLD DOORS USING DRYWALL
JAMB FACING = 1 1/4" + DOOR SIZE x (81 1/2")

R.O. FOR BYPASS DOORS USING DRYWALL
JAMB FACING MAKE SAME AS BOTH DOORS
ADDED TOGETHER

ALL INTERIOR DOORS
SIZE + 2" TO WIDTH x 82 1/2" HIGH

R.O. POCKET DOOR
(2x DOOR WIDTH + 1") x 85" HIGH

8'-0" CEILING HEIGHT
ON SECOND FLOOR

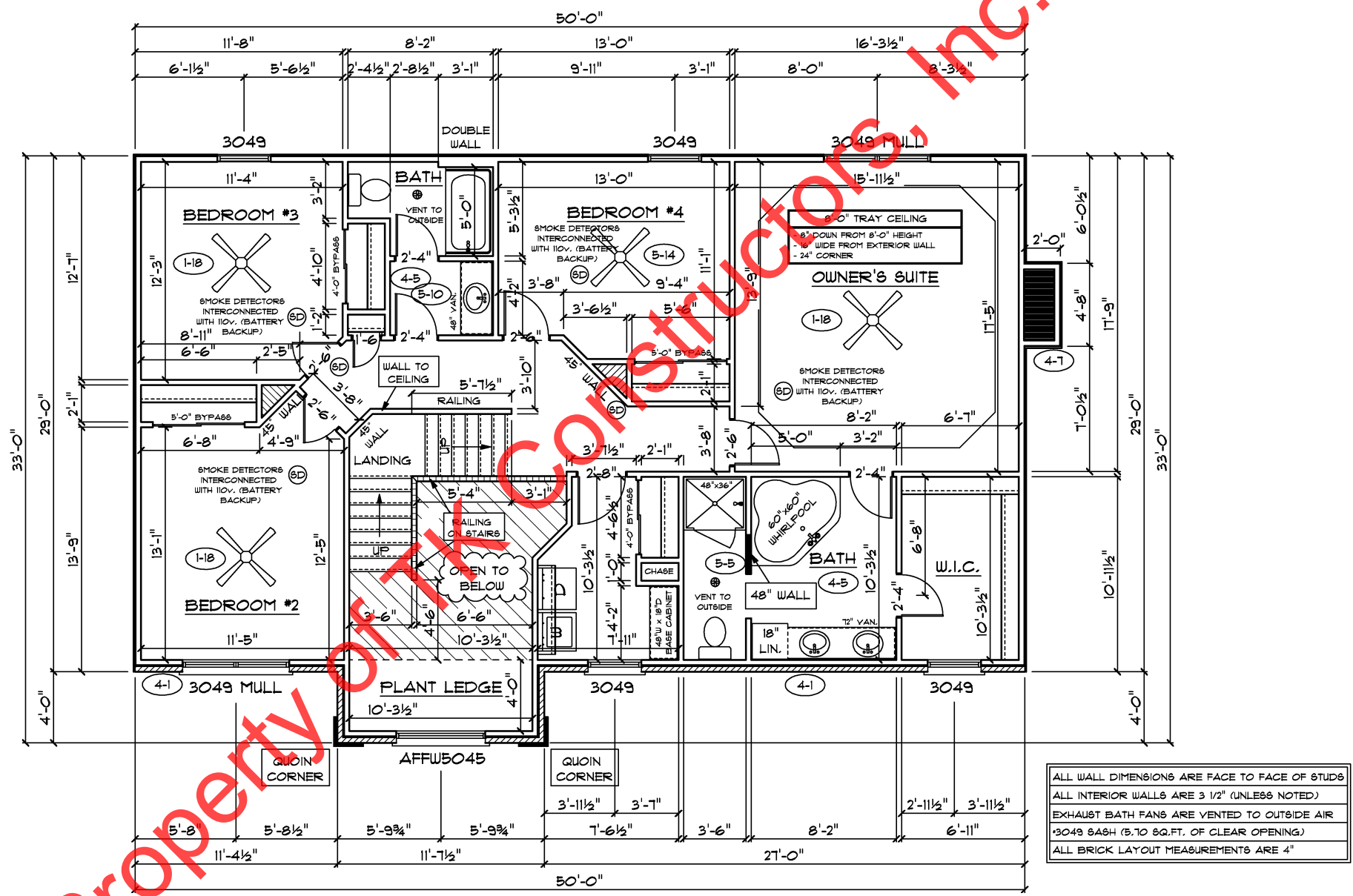

ALL WALL DIMENSIONS ARE FACE TO FACE OF STUDS
ALL INTERIOR WALLS ARE 3 1/2" (UNLESS NOTED)
EXHAUST BATH FANS ARE VENTED TO OUTSIDE AIR
*3049 SASH (5.70 SQ.FT. OF CLEAR OPENING)
ALL BRICK LAYOUT MEASUREMENTS ARE 4"

