

marked up 4-7-15

**PRINCETON STANDARD OPTIONS**

- DIRECT VENT FIREPLACE
- 9'-0" FIRST FLOOR CEILING HEIGHT
- 10/12 HIP ROOF
- SCHROCK RAISED PANEL OAK CABINETS
- 42" WALL CABINETS IN KITCHEN
- LEVEL 2 CARPET



REAR ELEVATION



FRONT ELEVATION

PAGE NO: **1B**

ADDENDUM 1, 4, 5

08:15 AM

DRAWING BY: SES, GW

1/8" = 1'

DATE: July 14, 2015

JOB NO: 210-15-0323

**TK CONSTRUCTORS**

PRINCETON

PROPERLY OF TK CONSTRUCTORS, INC

BATH

FLOOR PLAN

TOTAL LIVING SQ.FT.	2244
GARAGE	862
TOTAL SQ.FT.	3,106
EXCLUDING FRONT PORCH	51
EXCLUDING REAR DECK	158

ANDERSEN WINDOW SCHEDULE  
- 200 SERIES -

ANDERSEN MODEL NO.	R.O. SIZE
3030	36" x 36"
3040	36" x 48"
3049*	36" x 51"
3056*	36" x 66"
3060*	36" x 72"
3049 MULL*	73" x 51"
3056 MULL*	73" x 66"
3060 MULL*	73" x 72"

ANDERSEN SLIDING DOOR R.O. 72 3/4" x 82 1/8"
3'-0" FRONT DOOR R.O. 38 3/8" x 82 1/2"
3'-0" FRONT DOOR WITH (1) SIDELITE R.O. 51 1/8" x 82 1/2"
3'-0" FRONT DOOR WITH (2) SIDELITES R.O. 65 3/8" x 82 1/2"
R.O. FOR BI-FOLD DOORS USING DRYWALL JAMB FACING = 1 1/4" + DOOR SIZE x (81 1/2")
R.O. FOR BYPASS DOORS USING DRYWALL JAMB FACING MAKE SAME AS BOTH DOORS ADDED TOGETHER
ALL INTERIOR DOORS SIZE = 2" TO WIDTH x 82 1/2" HIGH
R.O. POCKET DOOR (2x DOOR WIDTH + 1") x 85" HIGH

9'-0" FIRST FLOOR  
CEILING HEIGHT

INCLUDES:

- 4 1/4" BASEBOARDS IN LIEU OF 3 1/4"
- 42" KITCHEN CABINETS
- (3) 9'x8' GARAGE DOORS (I-74)

ALL WALL DIMENSIONS ARE FACE TO FACE OF STUDO  
ALL INTERIOR WALLS ARE 3/2" (UNLESS NOTED)  
EXHAUST BATH FANS ARE VENTED TO OUTSIDE AIR  
(3049 BATH (8.10 SQ.FT. OF CLEAR OPENING)  
ALL BRICK LAYOUT MEASUREMENTS ARE 4"

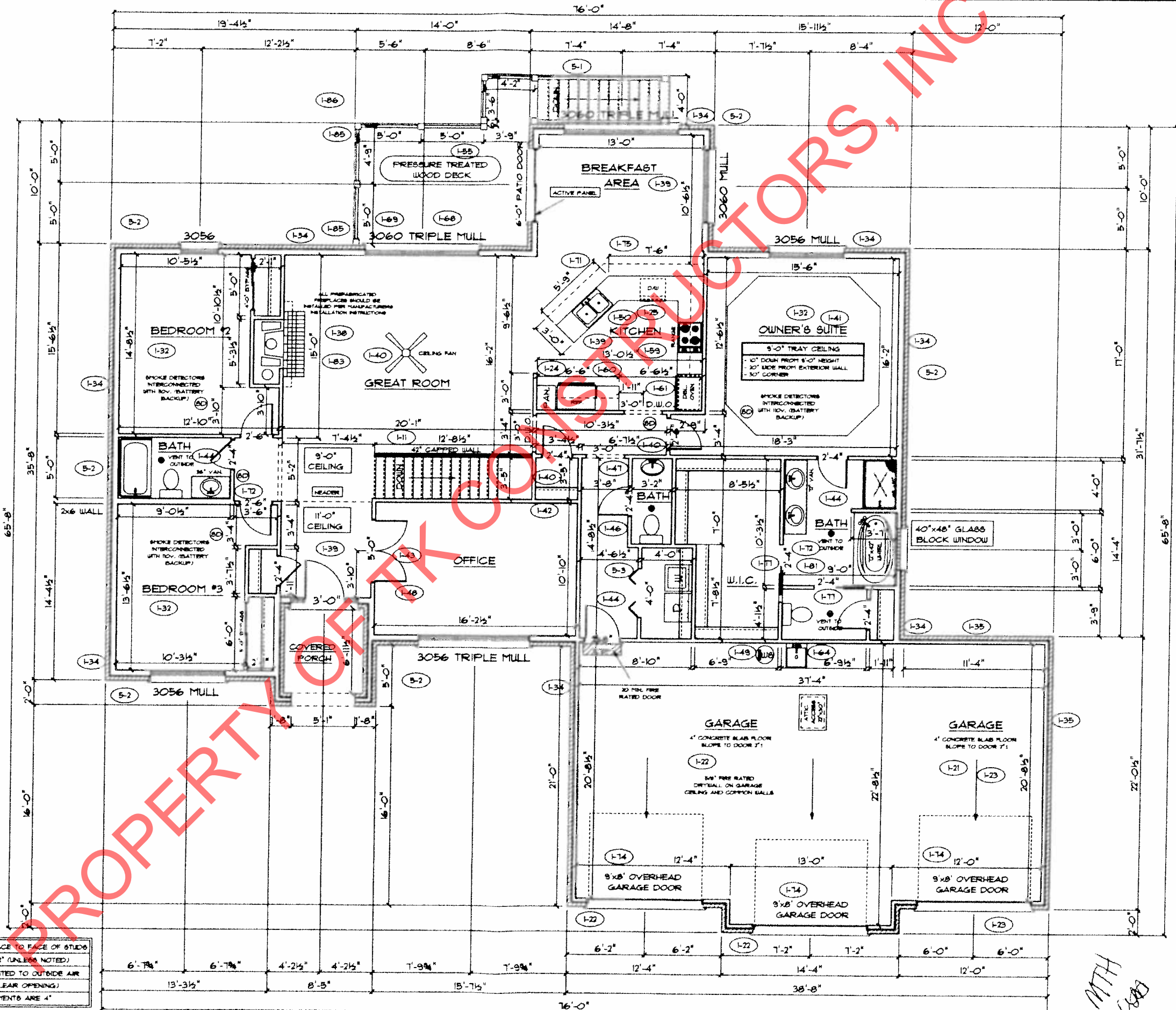

TK CONSTRUCTORS  
PRINCETON

DATE: July 14, 2015  
JOB NO.: 210-15-0323

ADDENDUM 1, 4, 5  
08:38 AM  
DRAWING BY: SES, GW  
1/8" = 1'  
CONSTRUCTORS

PAGE NO.: 3B