

NOTE: STOOPS, STEPS, APRON AND DRIVE BY OWNER

REAR ELEVATION

PRINCETON STANDARD OPTIONS	
9'-0" FIRST FLOOR CEILING HEIGHT	
10/12 HIP ROOF	
PRINCETON RAISED PANEL MAPLE CABINETS	
42" WALL CABINETS IN KITCHEN	
LEVEL 2 CARPET	

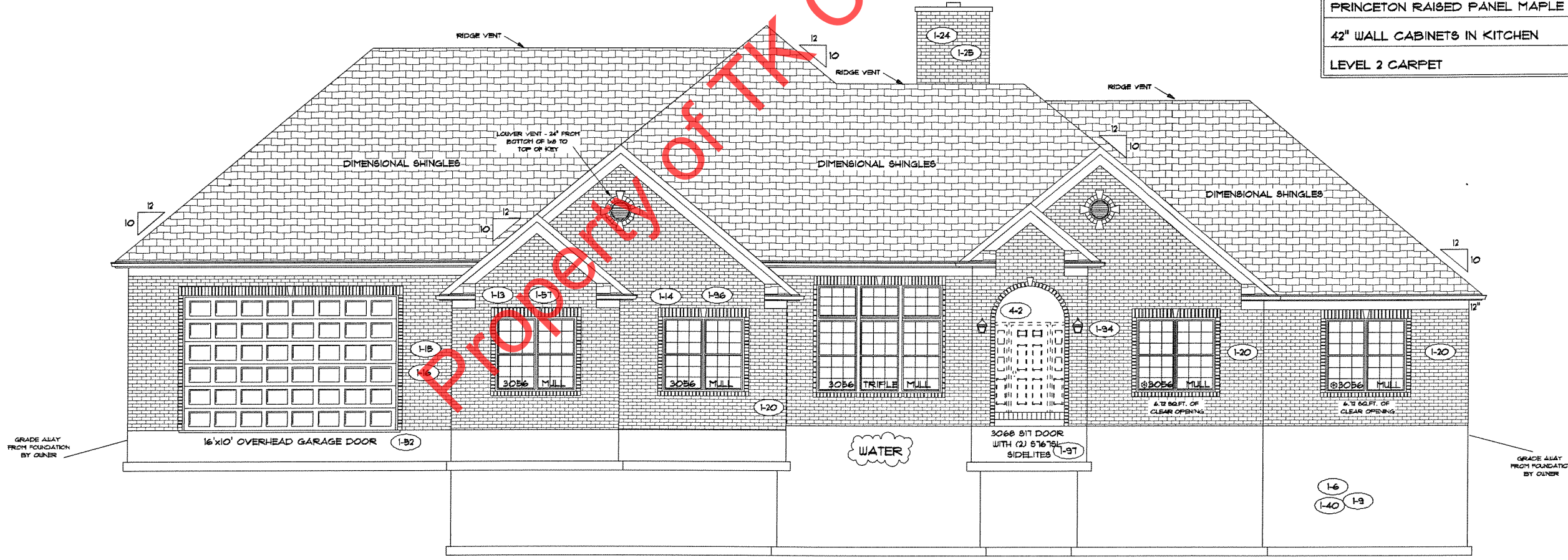

18" FOOTER WIDTH MIN.

FRONT ELEVATION

NOTE: STOOPS, STEPS, APRON AND DRIVE BY OWNER



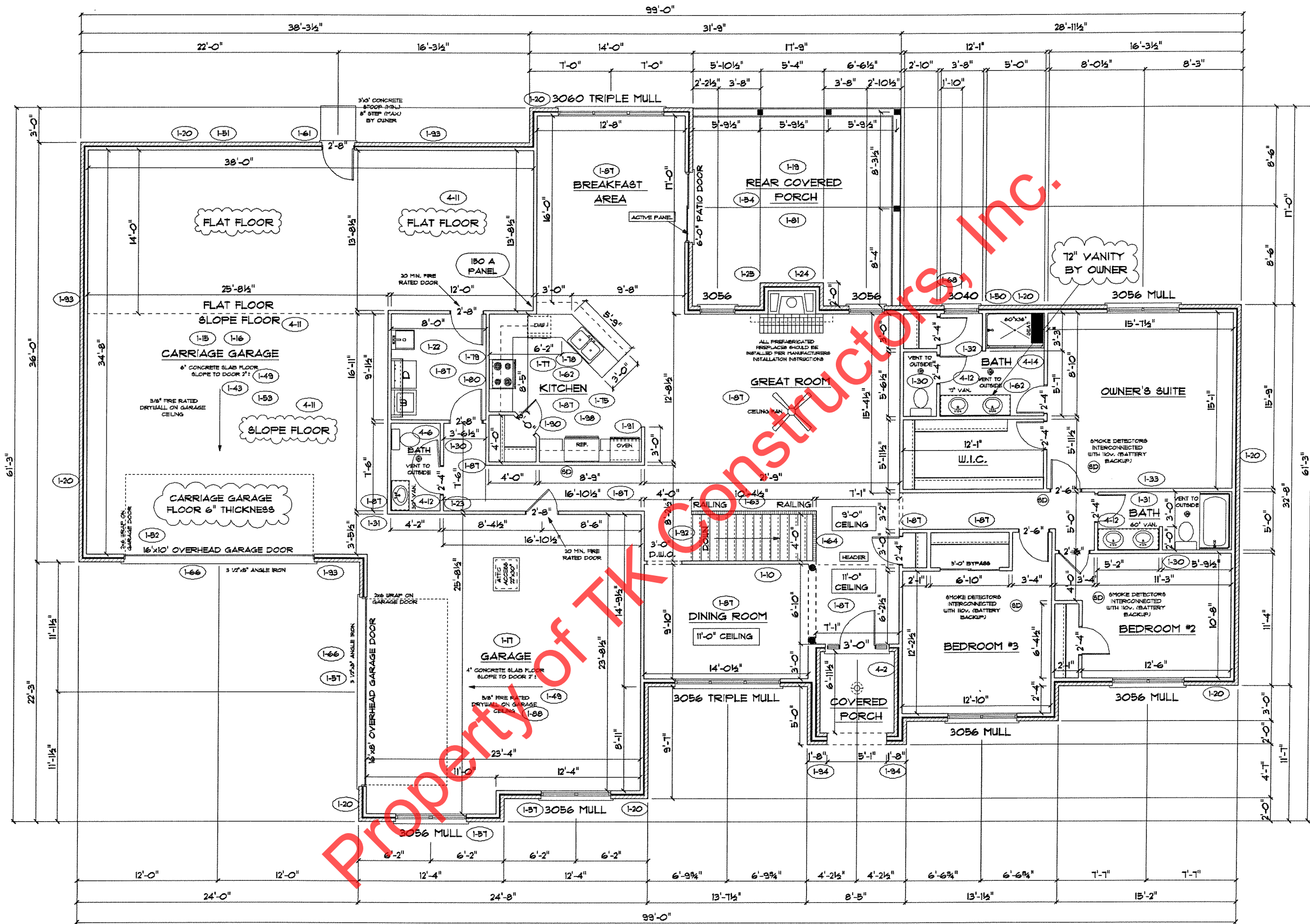

TOTAL LIVING SQ.FT.	2,304
GARAGE	1,732
TOTAL SQ.FT.	4,036
EXCLUDING FRONT PORCH	57
EXCLUDING REAR PORCH	301

**FLOOR PLAN**

ALL WALL DIMENSIONS ARE FACE TO FACE OF STUDS  
 ALL INTERIOR WALLS ARE 3 1/2" (UNLESS NOTED)  
 EXHAUST BATH FANS ARE VENTED TO OUTSIDE AIR  
 3049 SASH (5.70 SQ.FT. OF CLEAR OPENING)  
 ALL BRICK LAYOUT MEASUREMENTS ARE 4"