

REAR ELEVATION



FRONT ELEVATION

PAGE NO.:

1B

ADDENDUM 1

VER: 092412

DRAWING BY: SES

1/8" = 1'



DATE: April 05, 2013

JOB NO.: 112-13-0020

TK CONSTRUCTORS
NEW ORLEANS

OK

FLOOR PLAN

TOTAL LIVING SQ.FT.	1,894
GARAGE	515
TOTAL SQ.FT.	2,409
EXCLUDING PORCH	120

ANDERSEN WINDOW SCHEDULE
- 200 SERIES -

ANDERSEN MODEL NO.	R.O. SIZE
3030	36" x 36"
3040	36" x 48"
3049*	36" x 51"
3056*	36" x 66"
3060*	36" x 72"
3049 MULL*	73" x 51"
3056 MULL*	73" x 66"
3060 MULL*	73" x 72"
ANDERSEN SLIDING DOOR R.O. 72 3/4" x 82 1/8"	
3'-0" FRONT DOOR R.O. 38 3/8" x 82 1/2"	
3'-0" FRONT DOOR WITH (1) SIDELITE R.O. 51 1/8" x 82 1/2"	
3'-0" FRONT DOOR WITH (2) SIDELITES R.O. 65 3/8" x 82 1/2"	
R.O. FOR BI-FOLD DOORS USING DRYWALL JAMB FACING = 1 1/4" + DOOR SIZE x (81 1/2")	
R.O. FOR BYPASS DOORS USING DRYWALL JAMB FACING MAKE SAME AS BOTH DOORS ADDED TOGETHER	
ALL INTERIOR DOORS 61/2" + 2" TO WIDTH x 82 1/2" HIGH	
R.O. POCKET DOOR (2x DOOR WIDTH + 1") x 85" HIGH	

* - DENOTES OPENING MEETS
EGRESS REQUIREMENTS

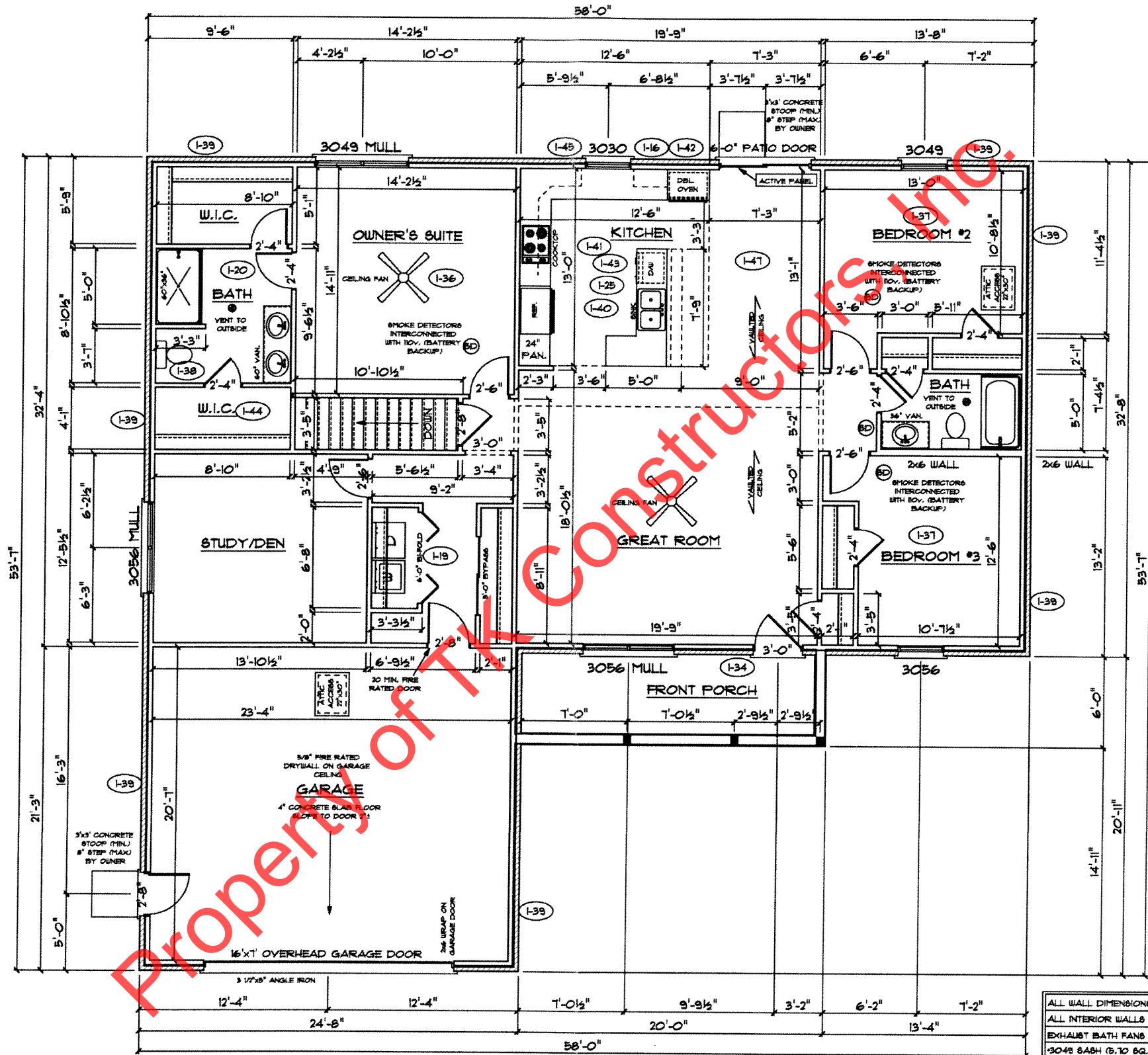

ALL WALL DIMENSIONS ARE FACE TO FACE OF STUDS
ALL INTERIOR WALLS ARE 3 1/2" (UNLESS NOTED)
EXHAUST BATH FANS ARE VENTED TO OUTSIDE AIR
3049 BATH (8.10 SQ.FT. OF CLEAR OPENING)
ALL BRICK LAYOUT MEASUREMENTS ARE 4"

PAGE NO.: **3B**

ADDENDUM 1
VER: 092412
DRAWING BY: SES
1/8" = 1'

TK CONSTRUCTORS
 NEW ORLEANS

DATE: April 09, 2013
JOB NO.: 112-13-0020

OK [Signature]