

1. ADDITIONAL SQ.FT. ADDED TO NEW ORLEANS
- LIVING SQ.FT. 65, GARAGE 0, PORCH 32

2. HIP ROOF ADDED TO HOME - 9/12 SIDE
PLANES, 7/12 FRONT AND BACK

3. PORCH IS NOW 152 SQ.FT.
(ADDITIONAL DEPTH NEEDED FOR CRAFTSMAN
STYLE OR BRICK POSTS)

4. ADDED (2) GABLES TO PORCH

5. FYPON WRAPPED PORCH POSTS

6. WINDOWS TRIMMED WITH BRICK ROWLOCK

7. ADDITIONAL WINDOW ADDED ON
GARAGE

8. GABLE RETURNS ON (1) GABLE

9. EYEBROWS ON (2) GABLES

10. FYPON LOUVER VENTS -

11. SIDE ENTRY GARAGE

12. ADDITIONAL WINDOW ADDED TO GREAT ROOM
(MULLED TO EXISTING)

13. DOOR WITH (2) SIDELITES

14. FIREPLACE MOVED TO KITCHEN WALL

15. ADDITIONAL WINDOW ADDED TO BEDROOM NO. 3



NEW ORLEANS ELITE

FLOOR PLAN

TOTAL LIVING SQ.FT.	1,894
GARAGE	474
TOTAL SQ.FT.	2,368
EXCLUDING PORCH	152

ANDERSEN WINDOW SCHEDULE - 200 SERIES -	
ANDERSEN MODEL NO.	R.O. SIZE
3030	36" x 36"
3040	36" x 48"
3049*	36" x 57"
3056*	36" x 66"
3060*	36" x 72"
3049 MULL*	73" x 57"
3056 MULL*	73" x 66"
3060 MULL*	73" x 72"
ANDERSEN SLIDING DOOR R.O. 12 3/4" x 82 1/8"	
3'-0" FRONT DOOR R.O. 38 3/8" x 82 1/2"	
3'-0" FRONT DOOR WITH (1) SIDELITE R.O. 51 7/8" x 82 1/2"	
3'-0" FRONT DOOR WITH (2) SIDELITES R.O. 65 3/8" x 82 1/2"	
R.O. FOR BI-FOLD DOORS USING DRYWALL JAMB FACING = 1 1/4" + DOOR SIZE x (81 1/2")	
R.O. FOR BYPASS DOORS USING DRYWALL JAMB FACING MAKE SAME AS BOTH DOORS ADDED TOGETHER	
ALL INTERIOR DOORS SIZE + 2" TO WIDTH x 82 1/2" HIGH	
R.O. POCKET DOOR (2x DOOR WIDTH + 1") x 85" HIGH	

* - DENOTES OPENING MEETS
EGRESS REQUIREMENTS

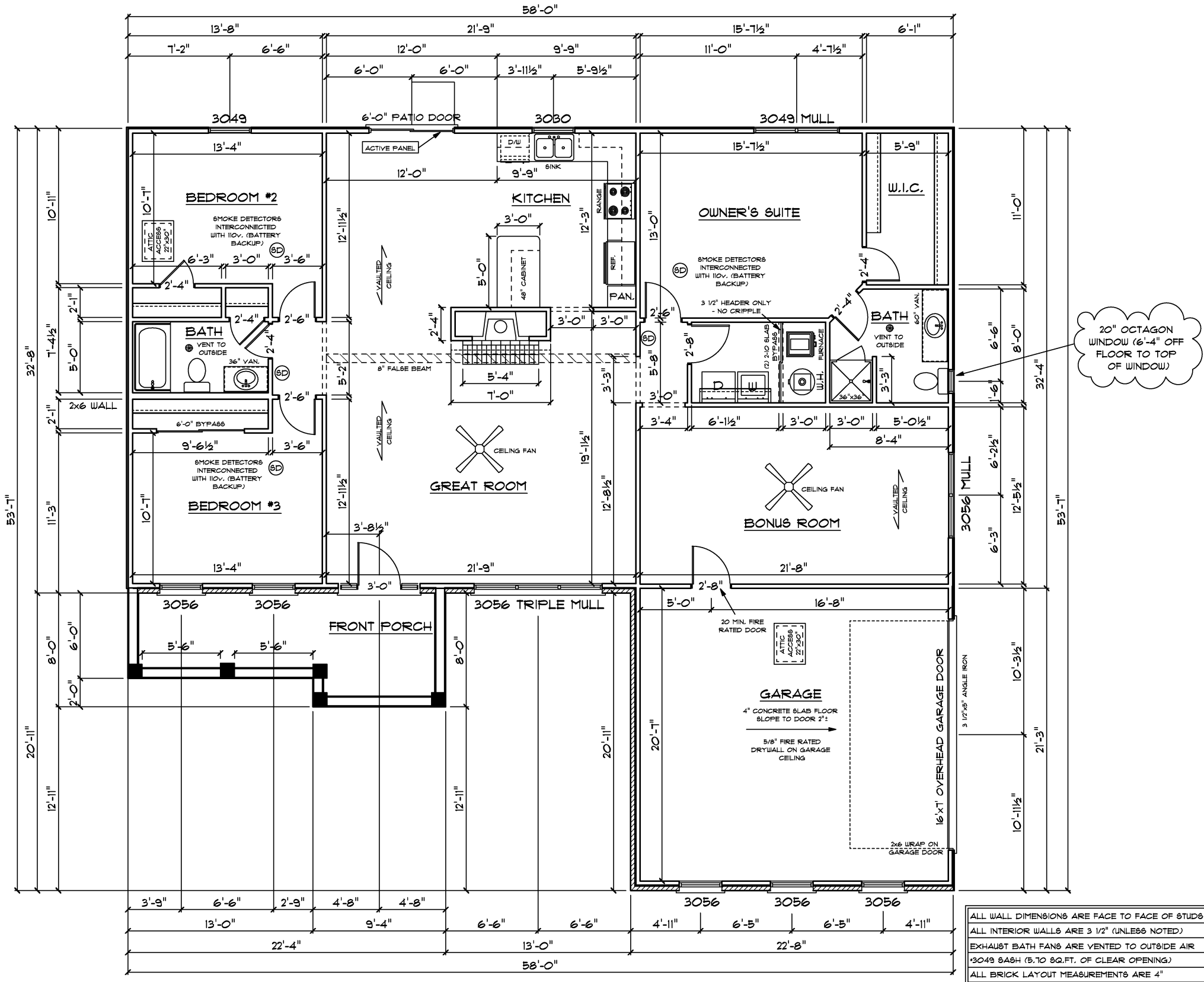

ALL WALL DIMENSIONS ARE FACE TO FACE OF STUDS
 ALL INTERIOR WALLS ARE 3 1/2" (UNLESS NOTED)
 EXHAUST BATH FANS ARE VENTED TO OUTSIDE AIR
 *3049 SASH (5.70 SQ.FT. OF CLEAR OPENING)
 ALL BRICK LAYOUT MEASUREMENTS ARE 4"

