

1. ADDITIONAL SQ.FT. ADDED TO MONTGOMERY
- LIVING SQ.FT. 127, GARAGE 19, PORCH 19

2. HIP ROOF ADDED TO HOME - 10/12 SIDE
PLANES, 9/12 FRONT AND BACK

3. PORCH IS NOW 8'-0"x4'-0"
(ADDITIONAL DEPTH NEEDED FOR CRAFTSMAN
STYLE OR BRICK POSTS)

4. ADDED GABLE TO GARAGE

5. ADDED (2) GABLES TO BEDROOM END

6. FYPON WRAPPED PORCH POSTS

7. STONE ADDED PER PLAN

8. ADDITIONAL WINDOW MULLED ON
GARAGE

9. GABLE RETURNS ON (2) GABLES

10. EYEBROWS ON (2) GABLES

11. (2) 24"x30" RECTANGULAR LOUVER
VENTS

12. SIDE ENTRY GARAGE

13. CIRCLE TOP ADDED TO BEDROOM NO. 3

14. VAULT ADDED TO BEDROOM NO. 3

15. ADDITIONAL WINDOW ADDED TO BEDROOM NO. 3
(MULLED TO EXISTING)

16. DOOR WITH (2) SIDELITES

17. FIREPLACE MOVED TO KITCHEN WALL

18. 9'-0" CEILING HEIGHT

19. 30" WALL CABINETS



MONTGOMERY ELITE

FLOOR PLAN

TOTAL LIVING SQ.FT.	1,657
GARAGE	492
TOTAL SQ.FT.	2,149
EXCLUDING PORCH	32

ANDERSEN WINDOW SCHEDULE - 200 SERIES -

ANDERSEN MODEL NO.	R.O. SIZE
3030	36" x 36"
3040	36" x 48"
3049*	36" x 57"
3056*	36" x 66"
3060*	36" x 72"
3049 MULL*	73" x 57"
3056 MULL*	73" x 66"
3060 MULL*	73" x 72"
ANDERSEN SLIDING DOOR R.O. 72 3/4" x 82 1/8"	
3'-0" FRONT DOOR R.O. 38 3/8" x 82 1/2"	
3'-0" FRONT DOOR WITH (1) SIDELITE R.O. 51 7/8" x 82 1/2"	
3'-0" FRONT DOOR WITH (2) SIDELITES R.O. 65 3/8" x 82 1/2"	
R.O. FOR BI-FOLD DOORS USING DRYWALL JAMB FACING = 1 1/4" + DOOR SIZE x (81 1/2")	
R.O. FOR BYPASS DOORS USING DRYWALL JAMB FACING MAKE SAME AS BOTH DOORS ADDED TOGETHER	
ALL INTERIOR DOORS SIZE + 2" TO WIDTH x 82 1/2" HIGH	
R.O. POCKET DOOR (2x DOOR WIDTH + 1") x 85" HIGH	

* - DENOTES OPENING MEETS EGRESS REQUIREMENTS

9'-0" FIRST FLOOR CEILING HEIGHT

INCLUDES:	
1.	4 1/4" BASEBOARDS IN LIEU OF 3 1/4"
2.	3060 WINDOWS IN LIEU OF 3056 WINDOWS
3.	3056 WINDOWS IN LIEU OF 3049 WINDOWS
4.	DRYWALL WRAPPED OPENINGS 12" TALLER
5.	30" KITCHEN CABINETS STANDARD (42" CABINETS AVAILABLE BUT NOT INCLUDED)
6.	16'x7' GARAGE DOOR STANDARD (16'x8' GARAGE DOOR AVAILABLE BUT NOT INCLUDED)

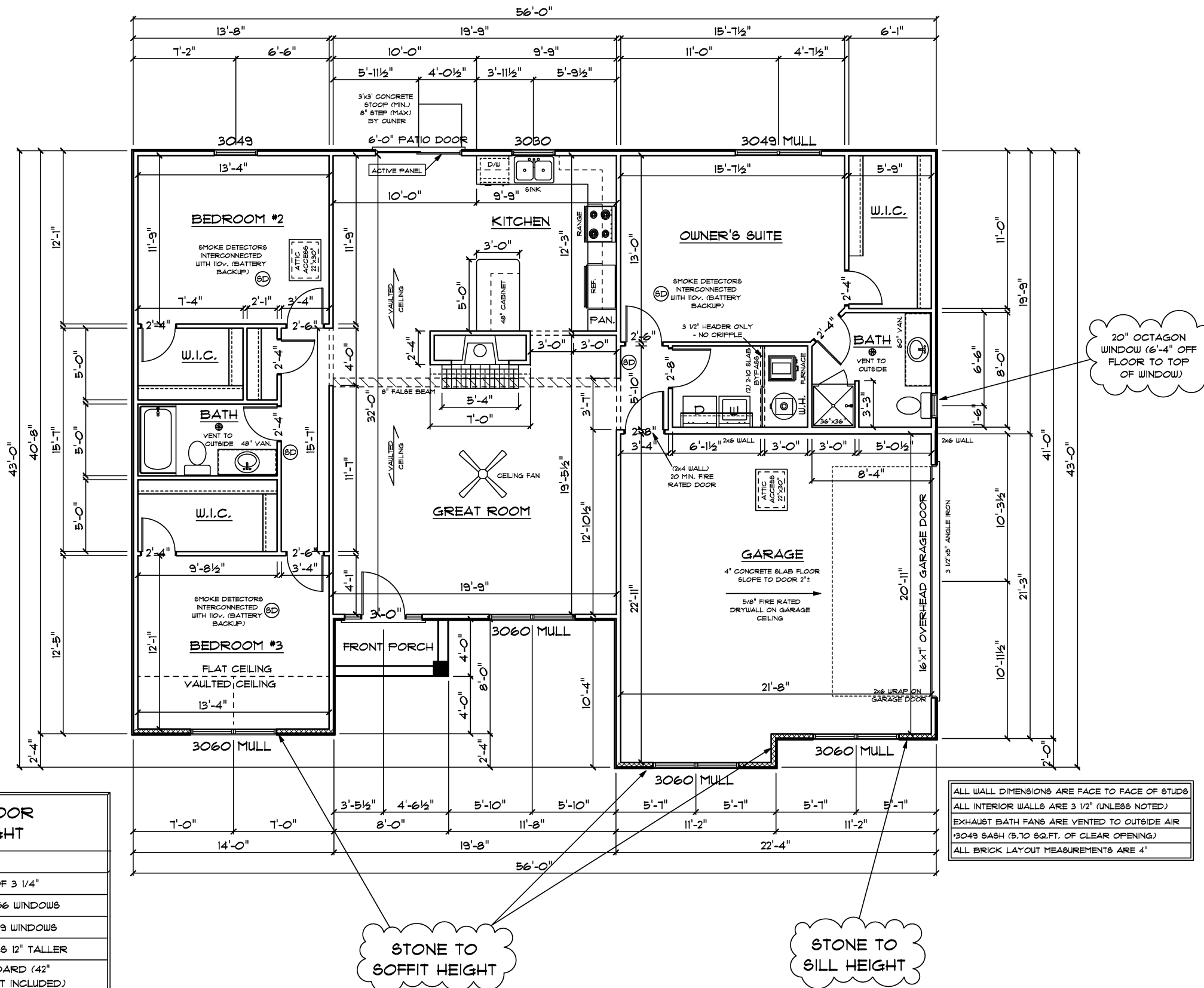

ALL WALL DIMENSIONS ARE FACE TO FACE OF STUDS
ALL INTERIOR WALLS ARE 3 1/2" (UNLESS NOTED)
EXHAUST BATH FANS ARE VENTED TO OUTSIDE AIR
*3049 SASH (5.70 SQ.FT. OF CLEAR OPENING)
ALL BRICK LAYOUT MEASUREMENTS ARE 4"

