

FRONT ELEVATION

Property of TK Constructors, Inc.

5-13 1-61
1-53 1-62
FIRST FLOOR PLAN

ANDERSEN WINDOWS	
MODEL	R.O. SIZE
CXW 14	3'-0" 1/2" X 4'-0" 1/2"
CXW 15	3'-0" 1/2" X 5'-0" 3/8"
CXW 16	3'-0" 1/2" X 6'-0" 3/8"
CXW 25	6'-0" 1/8" X 5'-0" 3/8"
CXW 145	3'-0" 1/2" X 4'-5" 3/8"
CXW 245	6'-0" 1/8" X 4'-5" 3/8"
CTR 23010	6'-0" 1/8" X 1'-0" 1/2"
CW 35	7'-1" 1/8" X 5'-0" 3/8"
ANDERSEN SLIDING DOOR R.O. 12 3/4" X 82 1/8"	
3/0 FRONT DOOR R.O. 3'-2 1/2" X 82 1/2"	
3/0 FRONT DOOR WITH (1) SIDE LIGHT R.O. 4'-3 1/2" X 82"	
3/0 FRONT DOOR WITH (2) SIDE LIGHTS R.O. 5'-5" X 82"	
R.O. FOR BYFOLD DOORS USING DRY-WALL JAMB FACING IS 1 1/4" DOOR SIZE	
R.O. FOR BYPASS DOORS USING DRYWALL JAMB FACING MAKE SAME AS BOTH DOORS ADDED TOGETHER	
ALL INTERIOR DOORS SIZE + 2" TO WIDTH X 82 1/2" HIGH	
R.O. POCKET DOOR - (2x DOOR WIDTH + 1") X 85" HIGH	

9'-0" FIRST FLOOR CEILING HEIGHT	
INCLUDES:	
1.	4 1/4" BASEBOARDS IN LIEU OF 3 1/4"
2.	3060 WINDOWS IN LIEU OF 3056 WINDOWS
3.	3056 WINDOWS IN LIEU OF 3049 WINDOWS
4.	DRYWALL WRAPPED OPENINGS 12" TALLER
5.	42" KITCHEN CABINETS STANDARD
6.	16'x8' GARAGE DOOR STANDARD

5-11
CLOSET SHELVING TO BE DELIVERED BUT NOT INSTALLED

5-14
ALL FLOORING BY OWNER INCLUDING PAD & UNDERLAYMENT

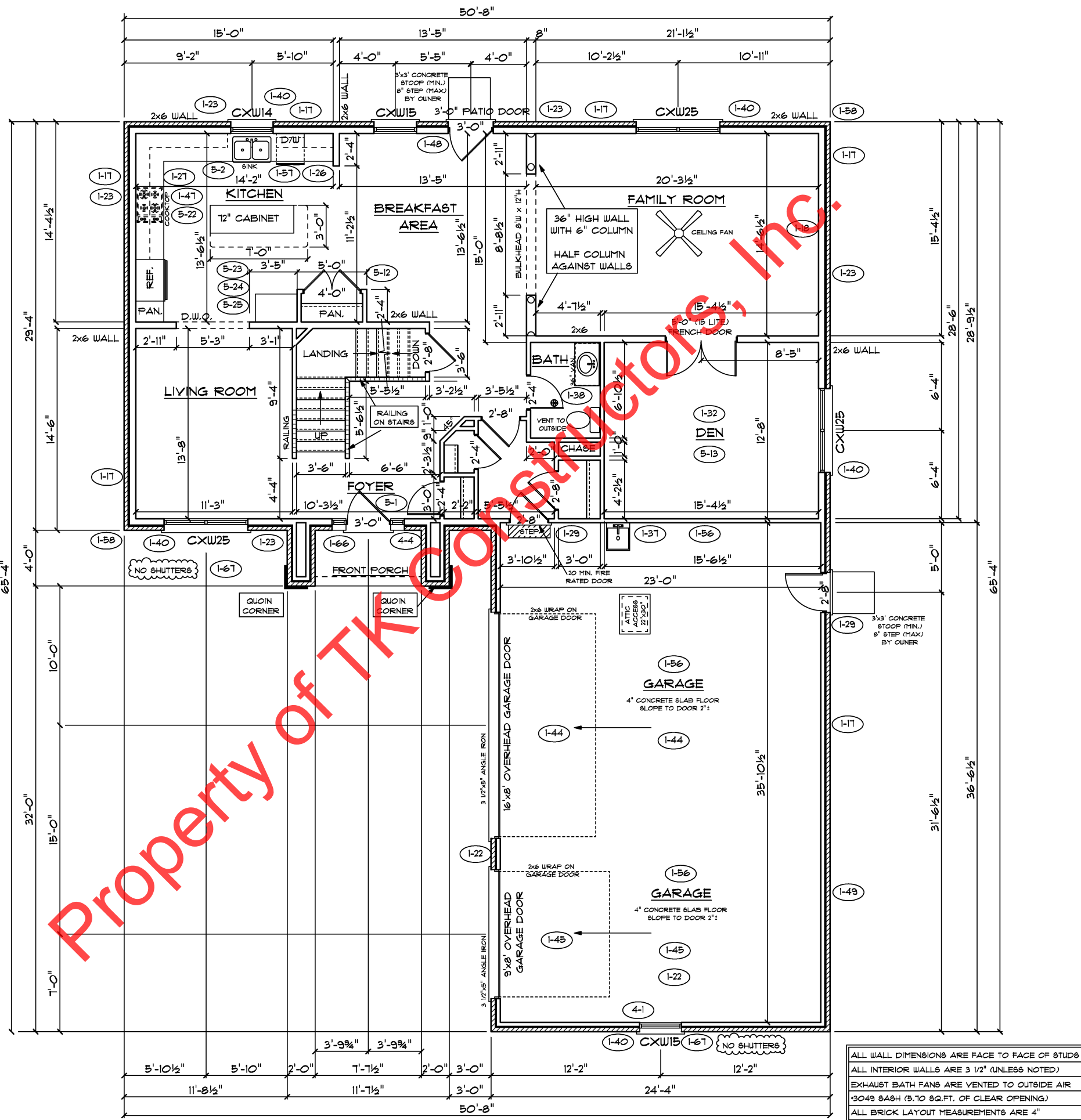

ALL WALL DIMENSIONS ARE FACE TO FACE OF STUDS
ALL INTERIOR WALLS ARE 3 1/2" (UNLESS NOTED)
EXHAUST BATH FANS ARE VENTED TO OUTSIDE AIR
13049 SASH (5.70 SQ.FT. OF CLEAR OPENING)
ALL BRICK LAYOUT MEASUREMENTS ARE 4"



1-39 5-13
SECOND FLOOR PLAN

First Floor Sq.ft.	1472
Second Floor Sq.ft.	1376
Total Living Sq.ft.	2848
Garage	887
Total Sq.ft.	3735
Excluding Porch	46

ANDERSEN WINDOWS	
MODEL	R.O. SIZE
CXW 14	3'-0" 1/2" X 4'-0" 1/2"
CXW 15	3'-0" 1/2" X 5'-0" 3/8"
CXW 16	3'-0" 1/2" X 6'-0" 3/8"
CXW 25	6'-0" 1/8" X 5'-0" 3/8"
CXW 145	3'-0" 1/2" X 4'-5" 3/8"
CXW 245	6'-0" 1/8" X 4'-5" 3/8"
CTR 23010	6'-0" 1/8" X 1'-0" 1/2"
CW 35	7'-1" 1/8" X 5'-0" 3/8"
ANDERSEN SLIDING DOOR R.O. 12 3/4" X 82 1/8"	
3/0 FRONT DOOR R.O. 3'-2 1/2" X 82 1/2"	
3/0 FRONT DOOR WITH (1) SIDE LIGHT R.O. 4'-3 1/2" X 82"	
3/0 FRONT DOOR WITH (2) SIDE LIGHTS R.O. 5'-5" X 82"	
R.O. FOR BYFOLD DOORS USING DRY-WALL JAMB FACING IS 1 1/4" + DOOR SIZE	
R.O. FOR BYPASS DOORS USING DRYWALL JAMB FACING MAKE SAME AS BOTH DOORS ADDED TOGETHER	
ALL INTERIOR DOORS SIZE + 2" TO WIDTH X 82 1/2" HIGH	
R.O. POCKET DOOR - (2x DOOR WIDTH + 1") X 85" HIGH	

8'-0" CEILING HEIGHT
ON SECOND FLOOR

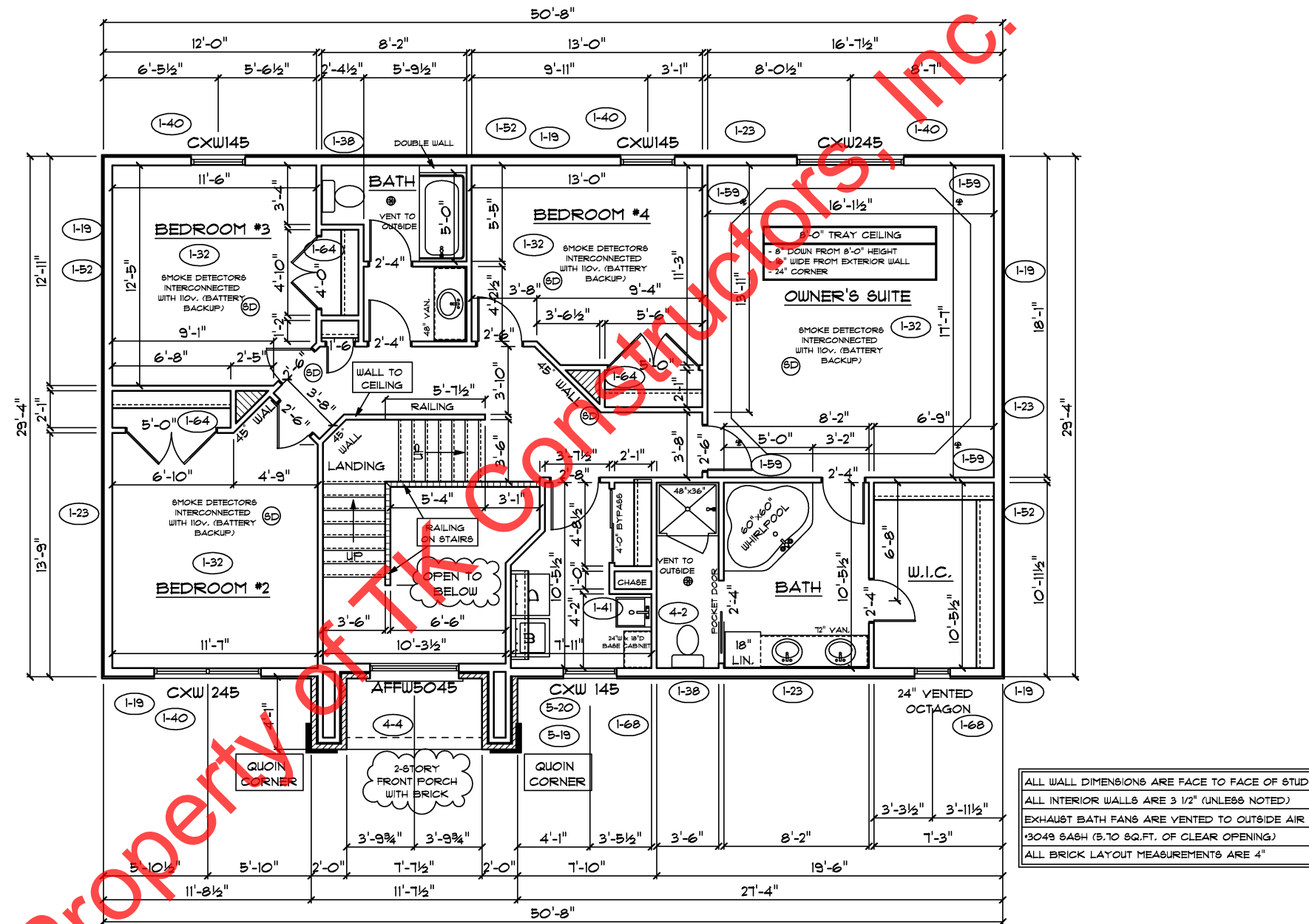

Property of TK Constructors, Inc.

