

MANCHESTER STANDARD OPTIONS

- 8/12 PITCH FRONT AND BACK PLANES
- 9/12 PITCH SIDE PLANES
- QUON CORNERS
- KEYSTONE ON GARAGE VENT
- 9'-0" FIRST FLOOR CEILING HEIGHT
- BCHROCK RAISED PANEL OAK CABINETS
- 42" WALL CABINETS
- LEVEL 2 BETTER CARPET AND PAD
- DIRECT VENT FIREPLACE
- ULTRA WASH DISHWASHER
- BILIANSTONE KITCHEN SINK
- CAN LIGHTS IN KITCHEN
- TRAY CEILING IN MASTER BEDROOM
- OAK RAILING ON STAIRS



FRONT ELEVATION

Property of TK Constructors, INC



FLOOR PLAN

ANDERSEN WINDOWS

MODEL	R.O. SIZE
3030	36" x 36"
3040	36" x 48"
3048	36" x 51"
3056	36" x 66"
3060	36" x 72"
3049S MULL	73" x 91"
3056 MULL	73" x 66"
3060 MULL	73" x 72"
ANDERSEN SLIDING DOOR R.O. 72 3/4" x 82 1/8"	
3/0 FRONT DOOR R.O. 3'-2 1/2" x 82 1/2"	
3/0 FRONT DOOR WITH (1) SIDE LIGHT R.O. 4'-3 1/2" x 82"	
3/0 FRONT DOOR WITH (2) SIDE LIGHTS R.O. 5'-5" x 82"	
R.O. FOR BYFOLD DOORS USING DRY-WALL JAMB FACING IS 1 1/4" DOOR SIZE	
R.O. FOR BYPASS DOORS USING DRY-WALL JAMB FACING MAKE SAME AS BOTH DOORS ADDED TOGETHER	
ALL INTERIOR DOORS SIZE + 2" TO WIDTH x 82 1/2" HIGH	
R.O. POCKET DOOR - (2) DOOR WIDTH + 1" x 85" HIGH	

9'-0" FIRST FLOOR
CEILING HEIGHT

INCLUDES:

1. 4 1/4" BASEBOARDS IN LIEU OF 3 1/4"
2. 3060 WINDOWS IN LIEU OF 3056 WINDOWS
3. 3056 WINDOWS IN LIEU OF 3049S WINDOWS
4. DRYWALL WRAPPED OPENINGS 12" TALLER
5. 42" KITCHEN CABINETS STANDARD
6. 16 1/8" GARAGE DOOR STANDARD

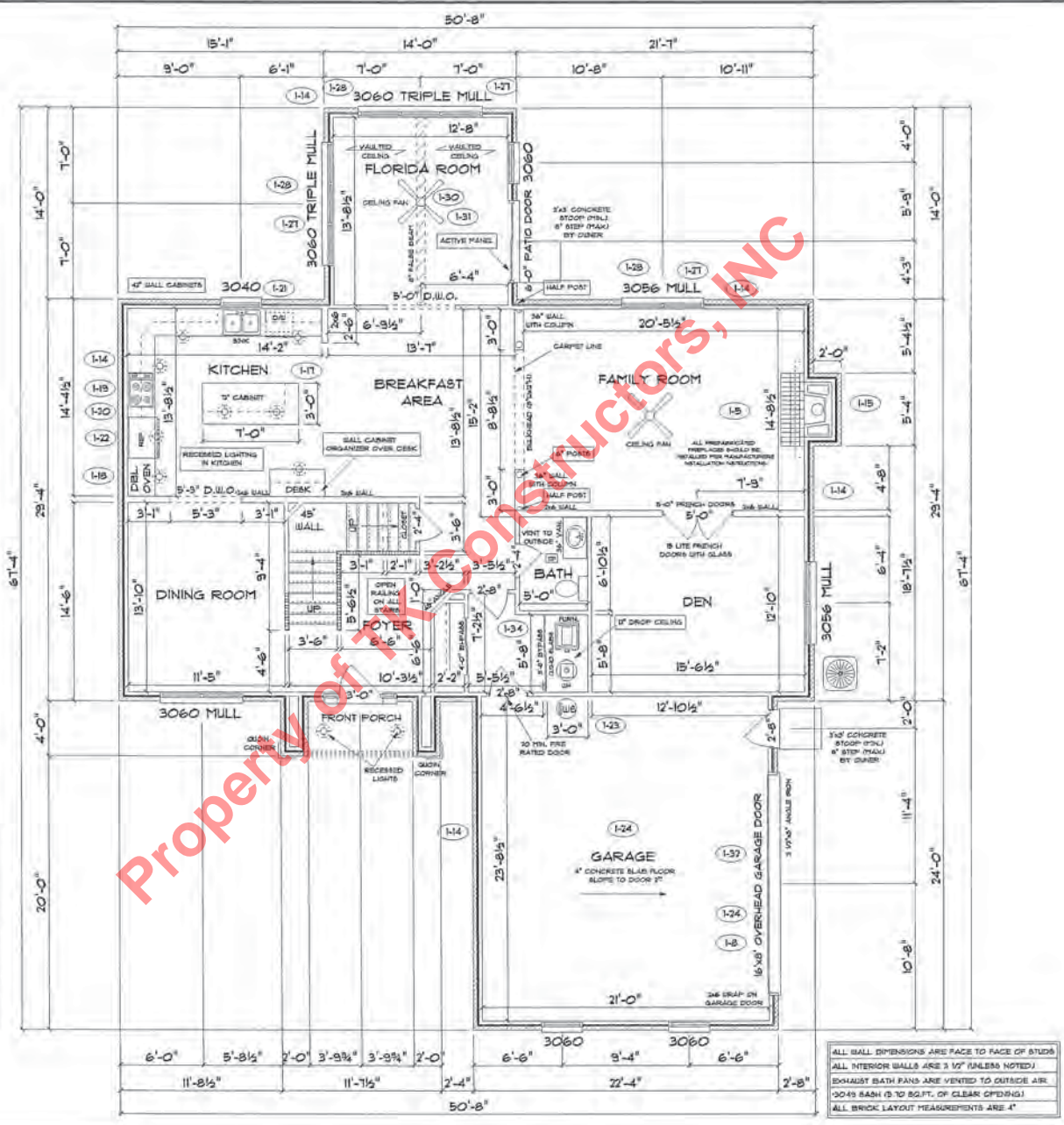

ALL WALL DIMENSIONS ARE FACE TO FACE OF STUDS
 ALL INTERIOR WALLS ARE 3/2" (UNLESS NOTED)
 EXHAUST BATH FANS ARE VENTED TO OUTSIDE AIR
 3049S BASH IS 10 SQ.FT. OF CLEAR OPENING
 ALL BRICK LAYOUT MEASUREMENTS ARE 4"

SECOND FLOOR

First Floor Sq.ft.	1,681
Second Floor Sq.ft.	1,362
Total Living Sq.ft.	3,043
Garage	536
Total Sq.ft.	3,579
Excluding Porch	46

ANDERSEN WINDOWS	
MODEL	R.O. SIZE
3030	36" x 36"
3040	36" x 48"
3049	36" x 51"
3056	36" x 66"
3060	36" x 72"
3049 MULL	13" x 51"
3056 MULL	13" x 66"
3060 MULL	13" x 72"
ANDERSEN SLIDING DOOR	
R.O. 12 3/4" x 82 1/8"	
3/0 FRONT DOOR	
R.O. 3'-2 1/2" x 82 1/2"	
3/0 FRONT DOOR WITH (1) SIDE LIGHT	
R.O. 4'-3 1/2" x 82"	
3/0 FRONT DOOR WITH (2) SIDE LIGHTS	
R.O. 5'-5" x 82"	
R.O. FOR BYFOLD DOORS USING DRY-WALL JAMB FACING IS 1 1/4" DOOR SIZE	
R.O. FOR BYPASS DOORS USING DRY-WALL JAMB FACING MAKE SAME AS BOTH DOORS ADDED TOGETHER	
ALL INTERIOR DOORS	
SIZE + 2" TO WIDTH x 82 1/2" HIGH	
R.O. POCKET DOOR - (2x) DOOR WIDTH + 1" x 85" HIGH	

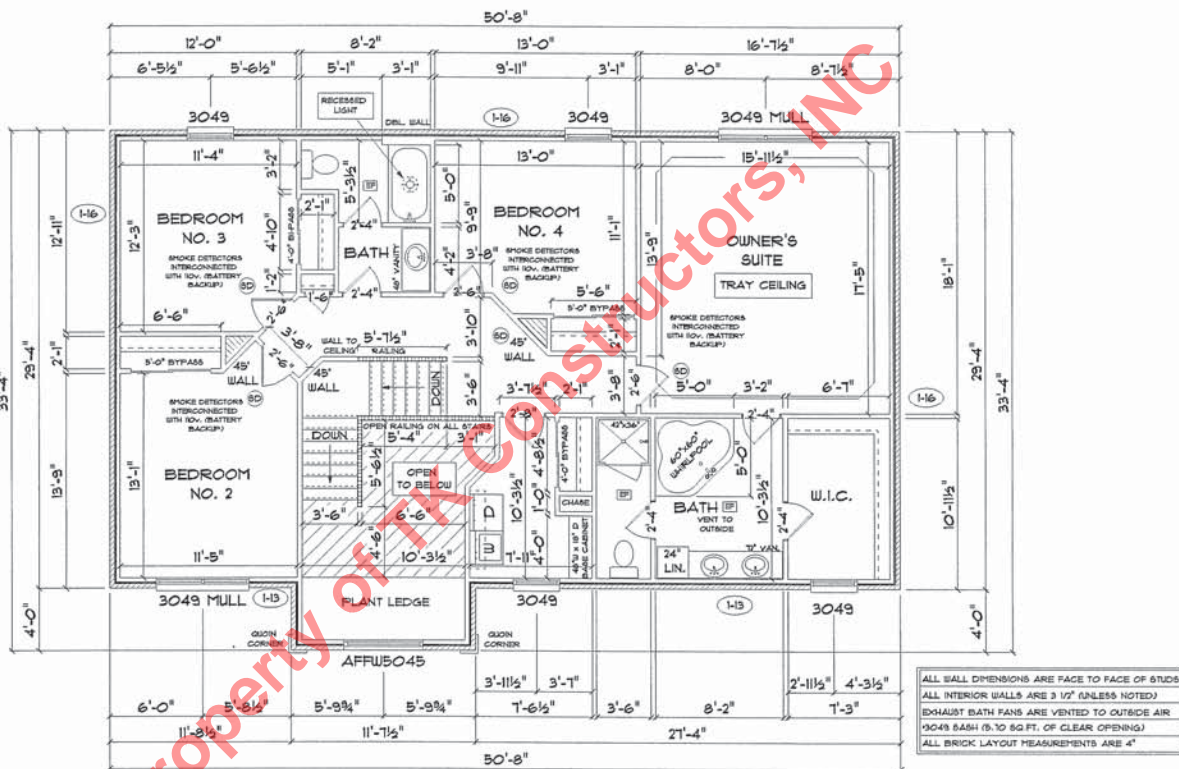

ALL WALL DIMENSIONS ARE FACE TO FACE OF STUDS
 ALL INTERIOR WALLS ARE 3 1/2" (UNLESS NOTED)
 EXHAUST BATH FANS ARE VENTED TO OUTSIDE AIR
 3049 BASH (5.10 SQ.FT. OF CLEAR OPENING)
 ALL BRICK LAYOUT MEASUREMENTS ARE 4"

8'-0" CEILINGS ON SECOND FLOOR