

marked up 6-9-13



REAR ELEVATION



FRONT ELEVATION

PAGE NO.: 10

ADDENDUM 1,4

VER: 092412

DRAWING BY: SES

1/8" = 1'

DATE: May 23, 2013

JOB NO.: 110-13-0123

TK CONSTRUCTORS

KNOXVILLE

M J [Signature]

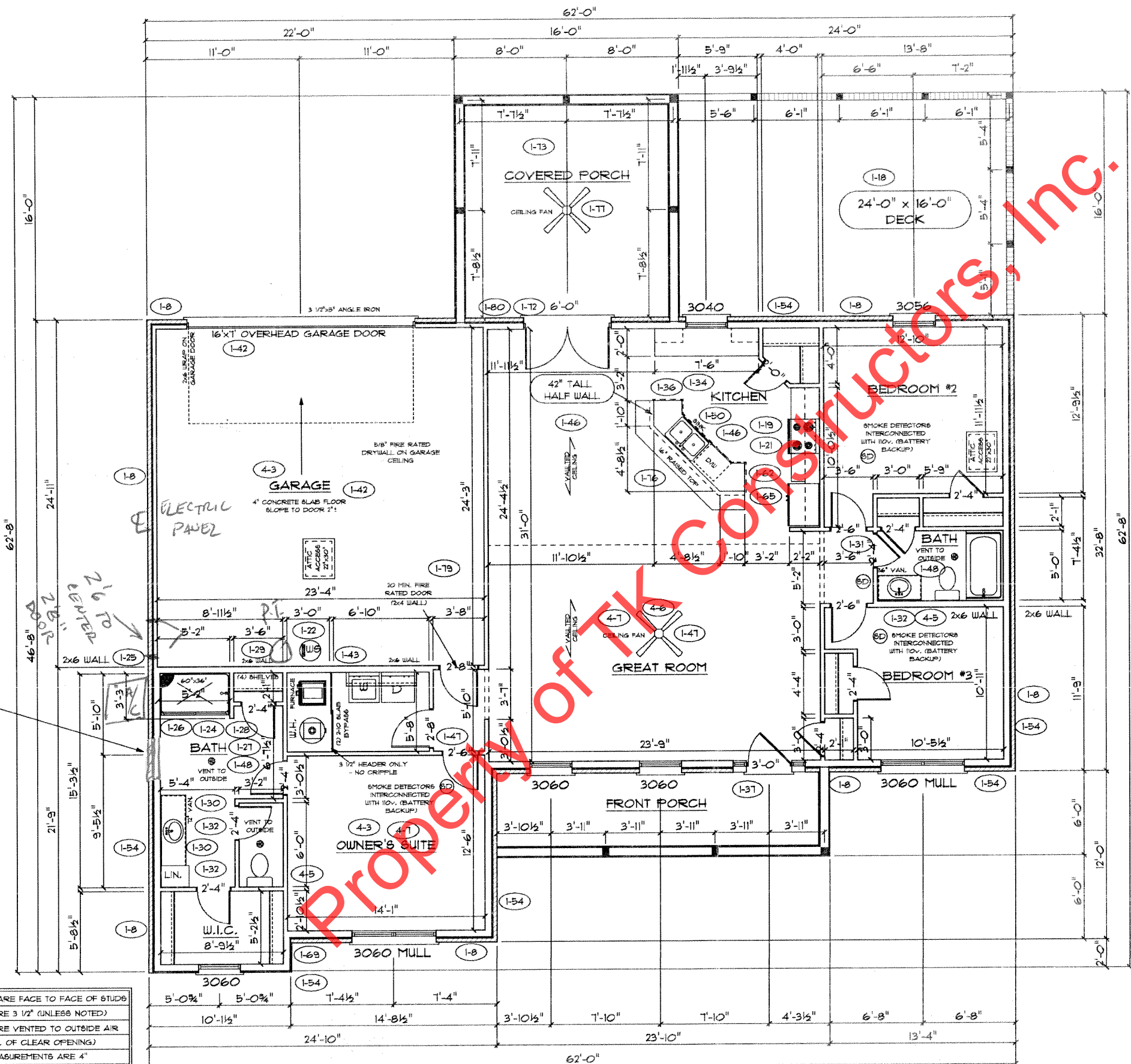

FLOOR PLAN

TOTAL LIVING SQ.FT.	1,671
GARAGE	627
TOTAL SQ.FT.	2,304
EXCLUDING FRONT PORCH	143
EXCLUDING REAR PORCH	256
DECK	384

ANDERSEN WINDOW SCHEDULE  
- 200 SERIES - (1-33)

ANDERSEN MODEL NO.	R.O. SIZE
3030	36" x 36"
3040	36" x 48"
3049*	36" x 57"
3056*	36" x 66"
3060*	36" x 72"
3049 MULL*	73" x 57"
3056 MULL*	73" x 66"
3060 MULL*	73" x 72"

- ANDERSEN SLIDING DOOR  
R.O. T2 3/4" x 82 1/8"
- 3'-0" FRONT DOOR  
R.O. 38 3/8" x 82 1/2"
- 3'-0" FRONT DOOR WITH (1) SIDELITE  
R.O. 51 1/8" x 82 1/2"
- 3'-0" FRONT DOOR WITH (2) SIDELITES  
R.O. 65 3/8" x 82 1/2"
- R.O. FOR BI-FOLD DOORS USING DRYWALL  
JAMB FACING = 1/4" + DOOR SIZE
- R.O. FOR BYPASS DOORS USING DRYWALL  
JAMB FACING MAKE SAME AS BOTH DOORS  
ADDED TOGETHER
- ALL INTERIOR DOORS  
SIZE + 2" TO WIDTH x 82 1/2" HIGH
- R.O. POCKET DOOR  
(2x DOOR WIDTH + 1") x 85" HIGH

\* - DENOTES OPENING MEETS  
EGRESS REQUIREMENTS

9'-0" FIRST FLOOR  
CEILING HEIGHT (1-51)

- INCLUDES:
- 4 1/4" BASEBOARDS IN LIEU OF 3 1/4"
  - 3060 WINDOWS IN LIEU OF 3056 WINDOWS
  - 3056 WINDOWS IN LIEU OF 3049 WINDOWS
  - DRYWALL WRAPPED OPENINGS 12" TALLER
  - 42" KITCHEN CABINETS (1-63)
  - 16'x1' GARAGE DOOR STANDARD

ALL WALL DIMENSIONS ARE FACE TO FACE OF STUDS  
ALL INTERIOR WALLS ARE 3/2" (UNLESS NOTED)  
EXHAUST BATH FANS ARE VENTED TO OUTSIDE AIR  
3049 SASH (6.10 SQ.FT. OF CLEAR OPENING)  
ALL BRICK LAYOUT MEASUREMENTS ARE 4"

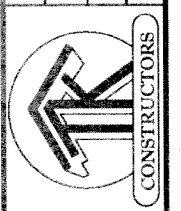

*Handwritten signature/initials*