



NOTE: STOOPS, STEPS, APRON AND DRIVE BY OWNER  
**REAR ELEVATION**  
 18" FOOTER WIDTH MIN.



18" FOOTER WIDTH MIN.  
**FRONT ELEVATION**  
 NOTE: STOOPS, STEPS, APRON AND DRIVE BY OWNER

JH  
 KA

<b>TK CONSTRUCTORS</b> <b>HARTFORD</b>	DATE: August 13, 2012	ADDENDUM 1,4 VER: 07/07/10 DRAWING BY: SES SCALE: 1/8 IN.=1 FT.	PAGE NO: <b>1B</b>
	JOB NO.: 111-12-0062	 CONSTRUCTORS	

8'-0" FLAT CEILING HEIGHT

FLOOR PLAN

Total Living Sq.ft.	1,799
Garage	514
Total Sq.ft.	2,313
Excluding Front Porch	24
Excluding Rear Porch	185

ANDERSEN WINDOWS	
MODEL	R.O. SIZE
3030	36" x 36"
3040	36" x 48"
3049	36" x 57"
3056	36" x 66"
3060	36" x 72"
3049 MULL	73" x 57"
3056 MULL	73" x 66"
3060 MULL	73" x 72"
ANDERSEN SLIDING DOOR R.O. 72 3/4" x 82 1/8"	
3/0 FRONT DOOR R.O. 3'-2 1/2" x 82 1/2"	
3/0 FRONT DOOR WITH (1) SIDE LIGHT R.O. 4'-3 1/2" x 82"	
3/0 FRONT DOOR WITH (2) SIDE LIGHTS R.O. 5'-5" x 82"	
R.O. FOR BYFOLD DOORS USING DRY-WALL JAMB FACING 18 1/4" DOOR SIZE	
R.O. FOR BYPASS DOORS USING DRYWALL JAMB FACING MAKE SAME AS BOTH DOORS ADDED TOGETHER	
ALL INTERIOR DOORS SIZE + 2" TO WIDTH x 82 1/2" HIGH	
R.O. POCKET DOOR - (2x DOOR WIDTH + 1") x 85" HIGH	

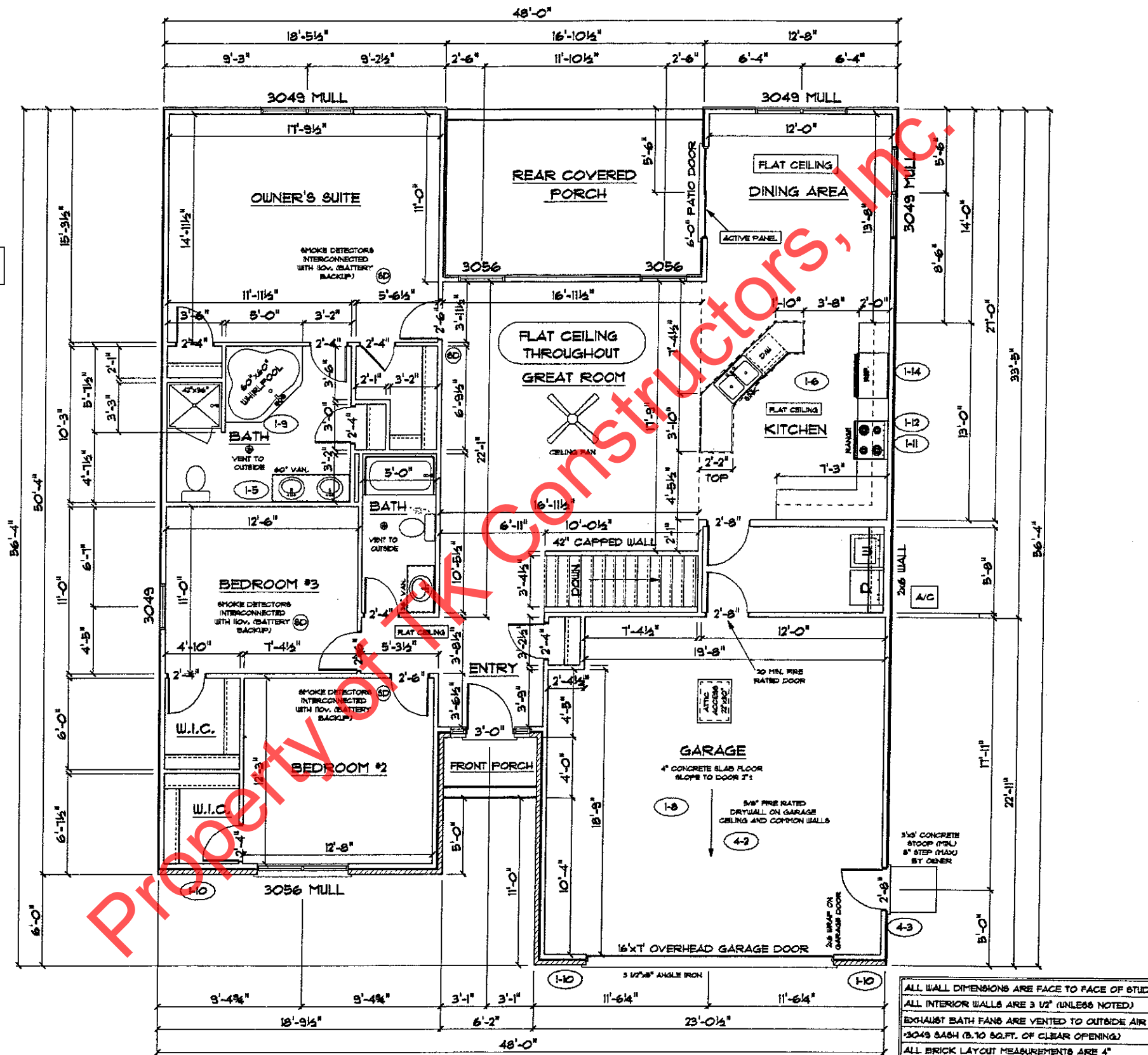

JF  
KH

