

Marked up 11-16-15



PROPERTY OF TK CONSTRUCTORS, INC

TK CONSTRUCTORS CAMBRIDGE		DATE: November 19, 2015	ADDENDUM 1,4	PAGE NO.: 1B
			VER: 08:27 AM	
			DRAWING BY: SES, GW	
			1/8" = 1'	
			CONSTRUCTORS	
		JOB NO.: 210-16-0301		

SECOND FLOOR PLAN

FIRST FLOOR SQ.FT.	1,376
SECOND FLOOR SQ.FT.	1,616
TOTAL LIVING SQ.FT.	2,992
GARAGE	843
TOTAL SQ.FT.	3,835
EXCLUDING PORCH	145

ANDERSEN WINDOW SCHEDULE - 200 SERIES -

ANDERSEN MODEL NO.	R.O. SIZE
3030	36" x 36"
3040	36" x 48"
3049*	36" x 57"
3056*	36" x 66"
3060*	36" x 72"
3049 MULL*	73" x 57"
3056 MULL*	73" x 66"
3060 MULL*	73" x 72"
ANDERSEN SLIDING DOOR R.O. 72 3/4" x 82 7/8"	
3'-0" FRONT DOOR R.O. 38 3/8" x 82 1/2"	
3'-0" FRONT DOOR WITH (1) SIDELITE R.O. 51 7/8" x 82 1/2"	
3'-0" FRONT DOOR WITH (2) SIDELITES R.O. 65 3/8" x 82 1/2"	
R.O. FOR BI-FOLD DOORS USING DRYWALL JAMB FACING = 1 1/4" + DOOR SIZE x (81 1/2")	
R.O. FOR BYPASS DOORS USING DRYWALL JAMB FACING MAKE SAME AS BOTH DOORS ADDED TOGETHER	
ALL INTERIOR DOORS SIZE + 2" TO WIDTH x 82 1/2" HIGH	
R.O. POCKET DOOR (2x DOOR WIDTH + 1") x 85" HIGH	

* - DENOTES OPENING MEETS EGRESS REQUIREMENTS

9'-0" SECOND FLOOR CEILING HEIGHT (1-63)

INCLUDES:
4 1/4" BASEBOARDS IN LIEU OF 3 1/4"

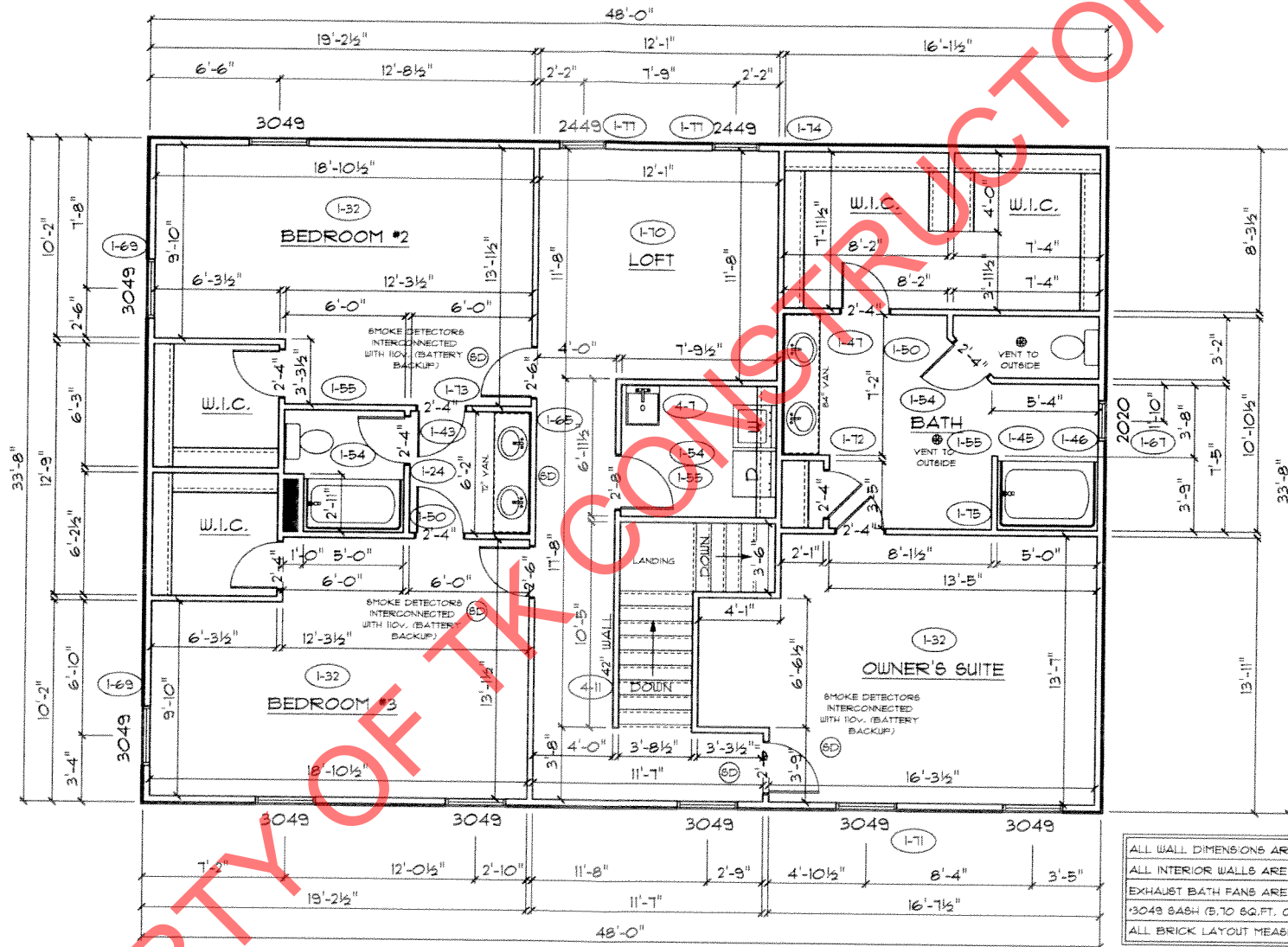

ALL WALL DIMENSIONS ARE FACE TO FACE OF STUDS
 ALL INTERIOR WALLS ARE 3/2" (UNLESS NOTED)
 EXHAUST BATH FANS ARE VENTED TO OUTSIDE AIR
 *3049 BASH (5.70 60. FT. OF CLEAR OPENING)
 ALL BRICK LAYOUT MEASUREMENTS ARE 4"