

FRONT ELEVATION

NOTE: STOOPS, STEPS, APRON AND DRIVE BY OWNER

Property of TK Constructors, Inc.



FIRST FLOOR PLAN

**ANDERSEN WINDOW SCHEDULE - 200 SERIES -**

ANDERSEN MODEL NO.	R.O. SIZE
3030	36" x 36"
3040	36" x 48"
3049*	36" x 57"
3056*	36" x 66"
3060*	36" x 72"
3049 MULL*	73" x 57"
3056 MULL*	73" x 66"
3060 MULL*	73" x 72"

ANDERSEN SLIDING DOOR  
R.O. 72 3/4" x 82 1/8"

3'-0" FRONT DOOR  
R.O. 38 3/8" x 82 1/2"

3'-0" FRONT DOOR WITH (1) SIDELITE  
R.O. 51 7/8" x 82 1/2"

3'-0" FRONT DOOR WITH (2) SIDELITES  
R.O. 65 3/8" x 82 1/2"

R.O. FOR BI-FOLD DOORS USING DRYWALL  
JAMB FACING = 1 1/4" + DOOR SIZE x (81 1/2")

R.O. FOR BYPASS DOORS USING DRYWALL  
JAMB FACING MAKE SAME AS BOTH DOORS  
ADDED TOGETHER

ALL INTERIOR DOORS  
SIZE + 2" TO WIDTH x 82 1/2" HIGH

R.O. POCKET DOOR  
(2x DOOR WIDTH + 1") x 85" HIGH

\* - DENOTES OPENING MEETS EGRESS REQUIREMENTS

**9'-0" FIRST FLOOR CEILING HEIGHT (1-87)**

- INCLUDES:
- 4 1/4" BASEBOARDS IN LIEU OF 3 1/4"
  - 3060 WINDOWS IN LIEU OF 3056 WINDOWS
  - 3056 WINDOWS IN LIEU OF 3049 WINDOWS
  - DRYWALL WRAPPED OPENINGS 12" TALLER
  - 42" KITCHEN CABINETS (1-74)
  - (3) 9'x8' GARAGE DOORS (1-45, 1-46, 1-47)

**CAMBRIDGE FIRST FLOOR STAIR DETAIL**

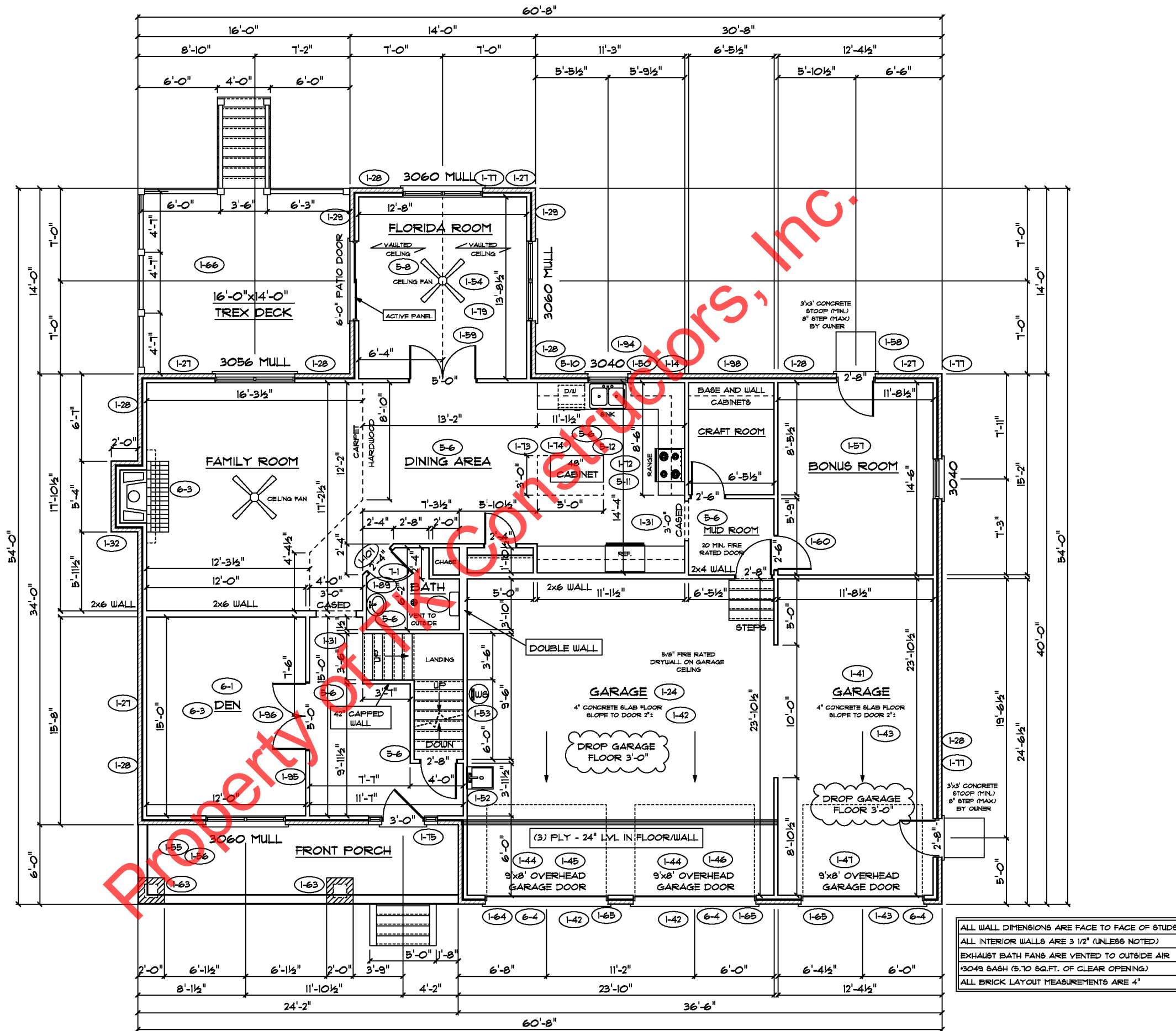
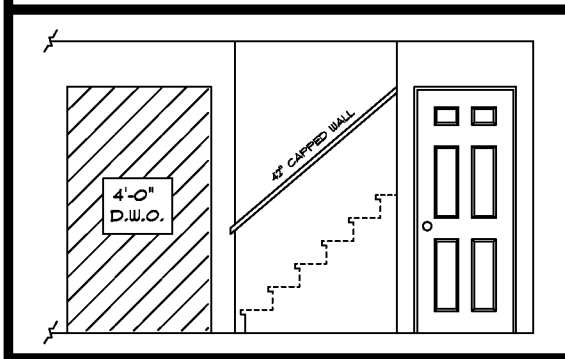

ALL WALL DIMENSIONS ARE FACE TO FACE OF STUDS  
ALL INTERIOR WALLS ARE 3 1/2" (UNLESS NOTED)  
EXHAUST BATH FANS ARE VENTED TO OUTSIDE AIR  
3049 SASH (5.70 SQ.FT. OF CLEAR OPENING)  
ALL BRICK LAYOUT MEASUREMENTS ARE 4"

TK CONSTRUCTORS  
CAMBRIDGE

DATE: May 14, 2013  
JOB NO.: 110-13-0101

ADDENDUM 1,4,5,6,7  
VER: 070710  
DRAWING BY: SES  
1/8" = 1'

CONSTRUCTORS

PAGE NO.: 4B

**SECOND FLOOR PLAN**

FIRST FLOOR SQ.FT.	1,594
SECOND FLOOR SQ.FT.	1,643
TOTAL LIVING SQ.FT.	3,237
GARAGE	883
TOTAL SQ.FT.	4,120
EXCLUDING FRONT PORCH	145
EXCLUDING REAR DECK	224

ANDERSEN WINDOW SCHEDULE - 200 SERIES -	
ANDERSEN MODEL NO.	R.O. SIZE
3030	36" x 36"
3040	36" x 48"
3049*	36" x 57"
3056*	36" x 66"
3060*	36" x 72"
3049 MULL*	73" x 57"
3056 MULL*	73" x 66"
3060 MULL*	73" x 72"
ANDERSEN SLIDING DOOR R.O. 12 3/4" x 82 1/8"	
3'-0" FRONT DOOR R.O. 38 3/8" x 82 1/2"	
3'-0" FRONT DOOR WITH (1) SIDELITE R.O. 51 1/8" x 82 1/2"	
3'-0" FRONT DOOR WITH (2) SIDELITES R.O. 65 3/8" x 82 1/2"	
R.O. FOR BI-FOLD DOORS USING DRYWALL JAMB FACING = 1 1/4" + DOOR SIZE x (81 1/2")	
R.O. FOR BYPASS DOORS USING DRYWALL JAMB FACING MAKE SAME AS BOTH DOORS ADDED TOGETHER	
ALL INTERIOR DOORS SIZE + 2" TO WIDTH x 82 1/2" HIGH	
R.O. POCKET DOOR (2x DOOR WIDTH + 1") x 85" HIGH	

\* - DENOTES OPENING MEETS  
EGRESS REQUIREMENTS

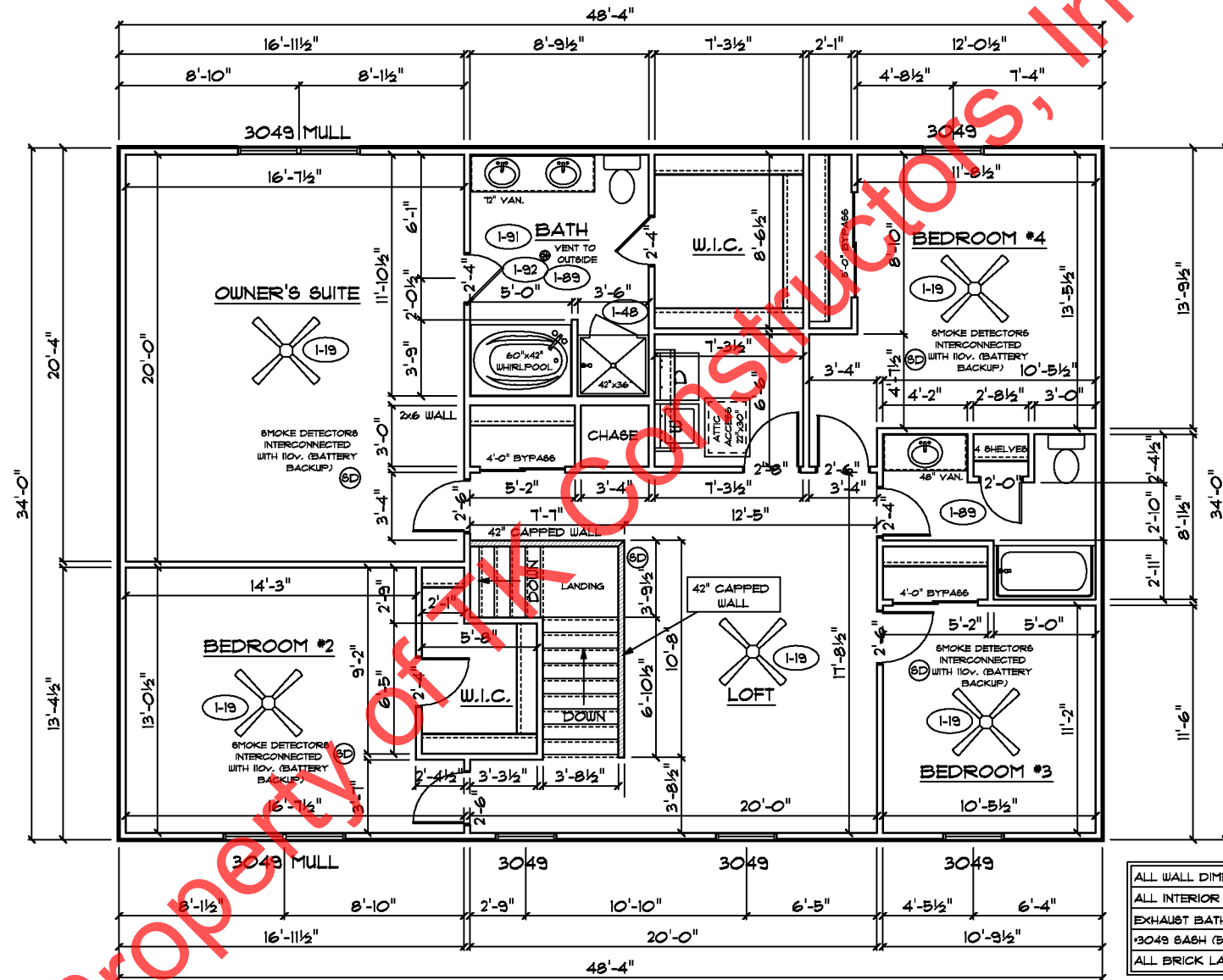

ALL WALL DIMENSIONS ARE FACE TO FACE OF STUDS  
 ALL INTERIOR WALLS ARE 3 1/2" (UNLESS NOTED)  
 EXHAUST BATH FANS ARE VENTED TO OUTSIDE AIR  
 \*3049 SASH (5.70 SQ.FT. OF CLEAR OPENING)  
 ALL BRICK LAYOUT MEASUREMENTS ARE 4"